



Afdichtingsystemen voor balkons, galerijen, loggia's en daken

EXPERTISE
FLOOR COATING





Balkons, loggia's en galerijen behoren door de open bouw tot de zwaarst belaste bouwdelen. Belasting door temperatuur, vochtigheid en intensief zonlicht, maar ook mechanische en chemische belasting, stellen daarom hoge eisen aan het bouwdeel.

Reactieharscoatings van MC-Bouwchemie garanderen een langdurige bescherming en waardebehoud van het vastgoed.

Regelrecht dicht

Bij het uitvoeren van alle afdichtingsmaatregelen moeten altijd de technische bouwvoorschriften in acht genomen worden genomen. Het uitvoeren van afdichtingsmaatregelen is beschreven in DIN 18531 "Afdichting van daken en balkons, loggia's en galerijen".

Europees geregeld

Het gebruik van een vloeibaar aangebracht afdichtingsmateriaal wordt daarentegen gereguleerd door een bouwtoezichtcertificaat (abP) of een Europese technische beoordeling (ETA). Deze documenten worden afgegeven op basis van het Europese beoordelingsdocument EAD 030350000402 (voorheen ETAG 005).

In deze brochure worden diverse coating- en afdichtingsconstructies gepresenteerd die bijdragen aan een betrouwbaar waarde behoud van het vastgoed. De systeemopbouw varieert van een eenvoudig kleurdesign met **MC-Dur Topspeed** tot een flexibele, duurzame afdichting met **MC-Dur Topspeed flex plus**.

MC-Dur Topspeed flex plus is een vloeibaar aan te brengen afdichtingssysteem dat voldoet aan de hoogste eisen volgens Europese specificaties. Deze omvatten bijvoorbeeld een levensduur van 25 jaar (**categorie W3**) en gebruik in extreme klimaatzones van -30 °C tot +90 °C (**categorieën TL4 & TH4**).

Gedetailleerd werk

Bij het uitvoeren van deze afdichtingsmaatregelen moet speciale aandacht worden besteed aan de gedetailleerde uitvoering van de verbindingen, aan- en afsluitingen voor doordringen, evenals voegenvorming.

Deze details worden niet geregeld door de bouwautoriteiten, maar mogen niet worden genegeerd om schade door gebruik en blootstelling aan milieu-invloeden te voorkomen. In deze brochure vindt u systeemstructuren voor verschillende toepassingen en de bijbehorende details.

MC-DUR TopSpeed – Het veelzijdig toepasbare coating- en afdichtingssysteem

Het coaten van balkons, loggia's, galerijen en daken stelt bijzondere eisen aan de planning en uitvoering van het coatingwerk. Naast nationale en Europese specificaties zijn er nog andere eisen waaraan een geschikt afdichtingssysteem moet voldoen.

Dit zijn bijvoorbeeld snelheid van uitvoering, vochtverdraagzaamheid, permanente UV- en kleurvastheid, evenals de mogelijkheid om verschillende opbouwsystemen te kunnen realiseren, afhankelijk van het gewenste ontwerp, toepassingsgebied en latere toepassing. De functie van dit systeem varieert van een eenvoudig kleurontwerp tot een duurzaam bestendige waterdichting onder plaatvormige bedekkingen tot de basis voor een duurzaam groendak.

- Verwerking bij 2 °C – 35 °C
- Vochtbestendig tijdens bouw
- Snelle uitharding
- Hoge scheuroverbrugging
- UV-bestendig





Inhoud

Primerlijst	7
Systeemopbouw	8 – 15
Eenvoudig kleurontwerp	10 – 11
Opbouw volgens EAD 030350-00-0402 (voorheen ETAG 005)	12
Opbouw conform DIN 18531	13 – 15
Afdichtingsdetails	16 – 39
01a: Vloer-wand-aansluiting	18
01b: Vloer-wand-aansluiting met tegels	19
02a: Isolatie	20
02b: Isolatie met tegels	21
03a: Stootvoegen	22
03b: Stootvoegen met tegels	23
04a: Randafwerking met goot	24
04b: Randafwerking met goot en tegels	25
05a: Deuraansluiting 5 cm	26
05b: Deuraansluiting 5 cm met tegels	27
06a: Deuraansluiting 15 cm	28
06b: Deuraansluiting 15 cm met tegels	29
07a: Deuraansluiting barrièrevrij	30
07b: Deuraansluiting barrièrevrij met tegels	31
08a: Buisdoorvoer	32
08b: Buisdoorvoer met tegels Geul	33
09a: zonder flens	34
09b: Geul zonder flens met tegels	35
10a: Geul met flens	36
10b: Geul met flens en tegels	37
11a: Relingvoet	38
11b: Relingvoet met tegels	39

Primerlijst



De passende basis voor verschillende ondergronden

Minerale ondergronden en tegels	
Grondering	MC-DUR 1177 WV-A
Schraaplaag	MC-DUR TopSpeed SC / MC-DUR 1320 VK (afstrooien)
Afdichtingslaag	MC-DUR TopSpeed flex plus
Weefsel	MC-Floor Tex
Staal	
Grondering	Colusal Speed Primer / Mycoflex 251
Afdichtingslaag	MC-DUR TopSpeed flex plus
Weefsel	MC-Floor Tex
RVS	
Grondering	Mycoflex 4100 TS
Afdichtingslaag	MC-DUR TopSpeed flex plus
Weefsel	MC-Floor Tex
Naaldhout, hardhout en schuimisolatie	
Grondering	MC-DUR 1177 WV-A
Afdichtingslaag	MC-DUR TopSpeed flex plus
Weefsel	MC-Floor Tex
Hard-PVC en GFK-polyester	
Grondering	Geen grondering noodzakelijk
Afdichtingslaag	MC-DUR TopSpeed flex plus
Weefsel	MC-Floor Tex

Systemopbouw

Systeemopbouw

Eenvoudig kleurontwerp

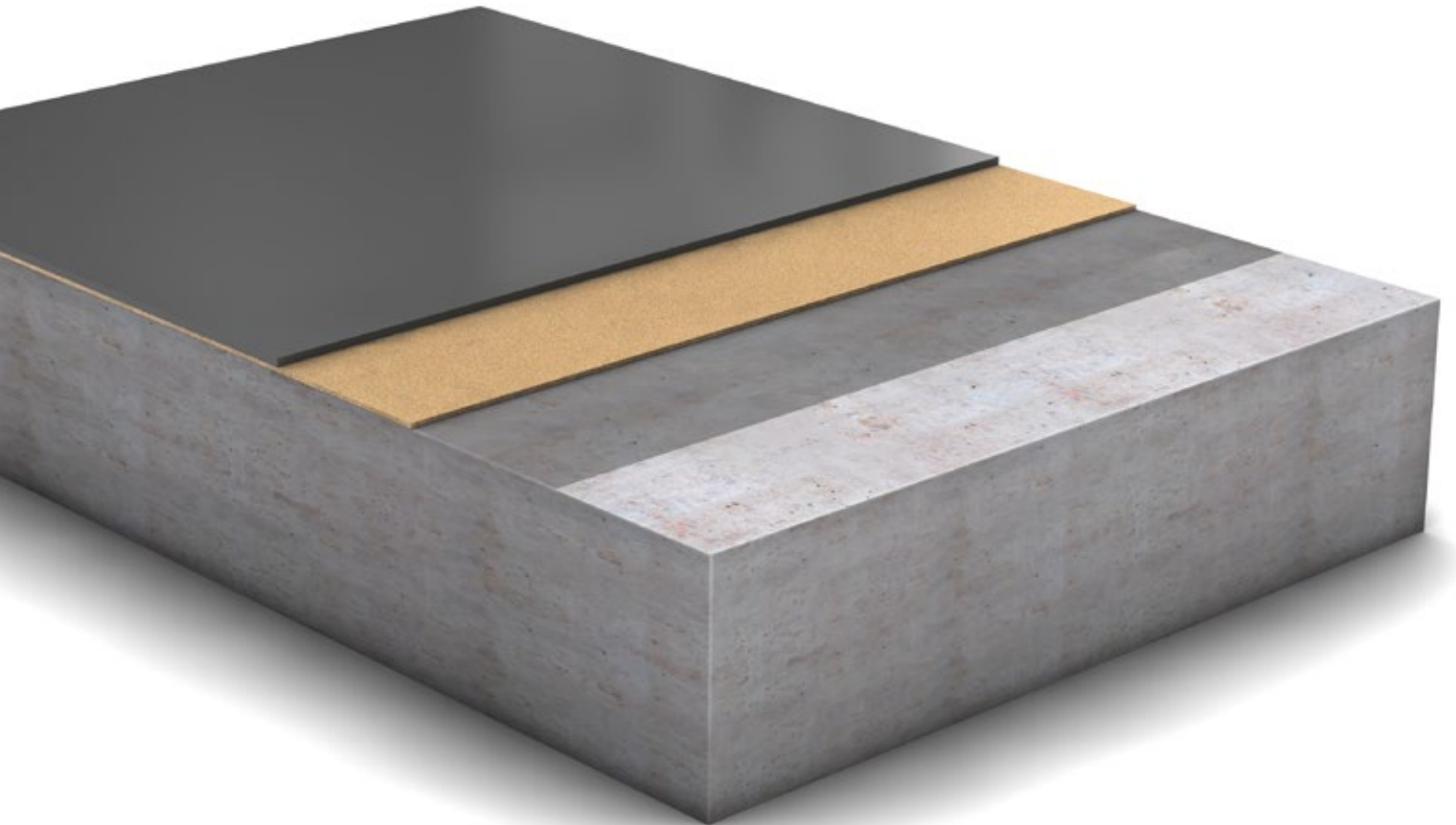

Grondering	MC-DUR 1177 WV-A	ca. 300 g/m ²
Schraaplaag	MC-DUR TopSpeed SC + KZ (1:1)	ca. 1.200 g/m ²
Verzegeling	MC-DUR TopSpeed + Glaspereels (3 - 5%)	ca. 2 x 250 g/m ²

KZ = Kwartszand

Systemopbouw

Eenvoudig kleurontwerp

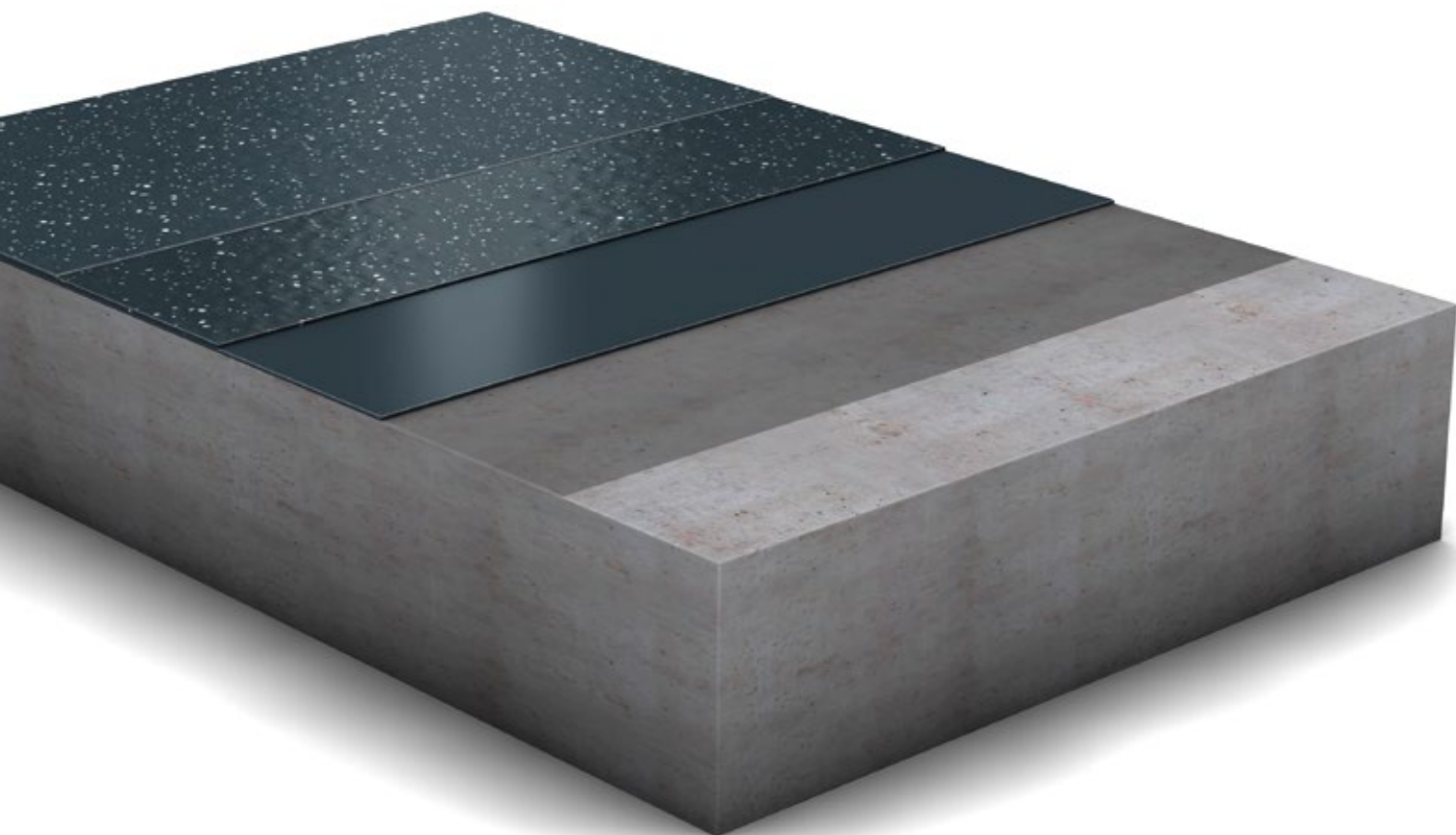

Grondering	MC-DUR 1177 WV-A	ca. 300 g/m ²
Coating	MC-DUR TopSpeed	ca. 2 x 250 g/m ²
Instrooiing	MC-Dekorchips	ca. 30 g/m ²
Verzegeling	MC-DUR TopSpeed M/T	ca. 150 g/m ²

Systemopbouw

Opbouw conform EAD 030350-00-0402 (voorheen ETAG 005)

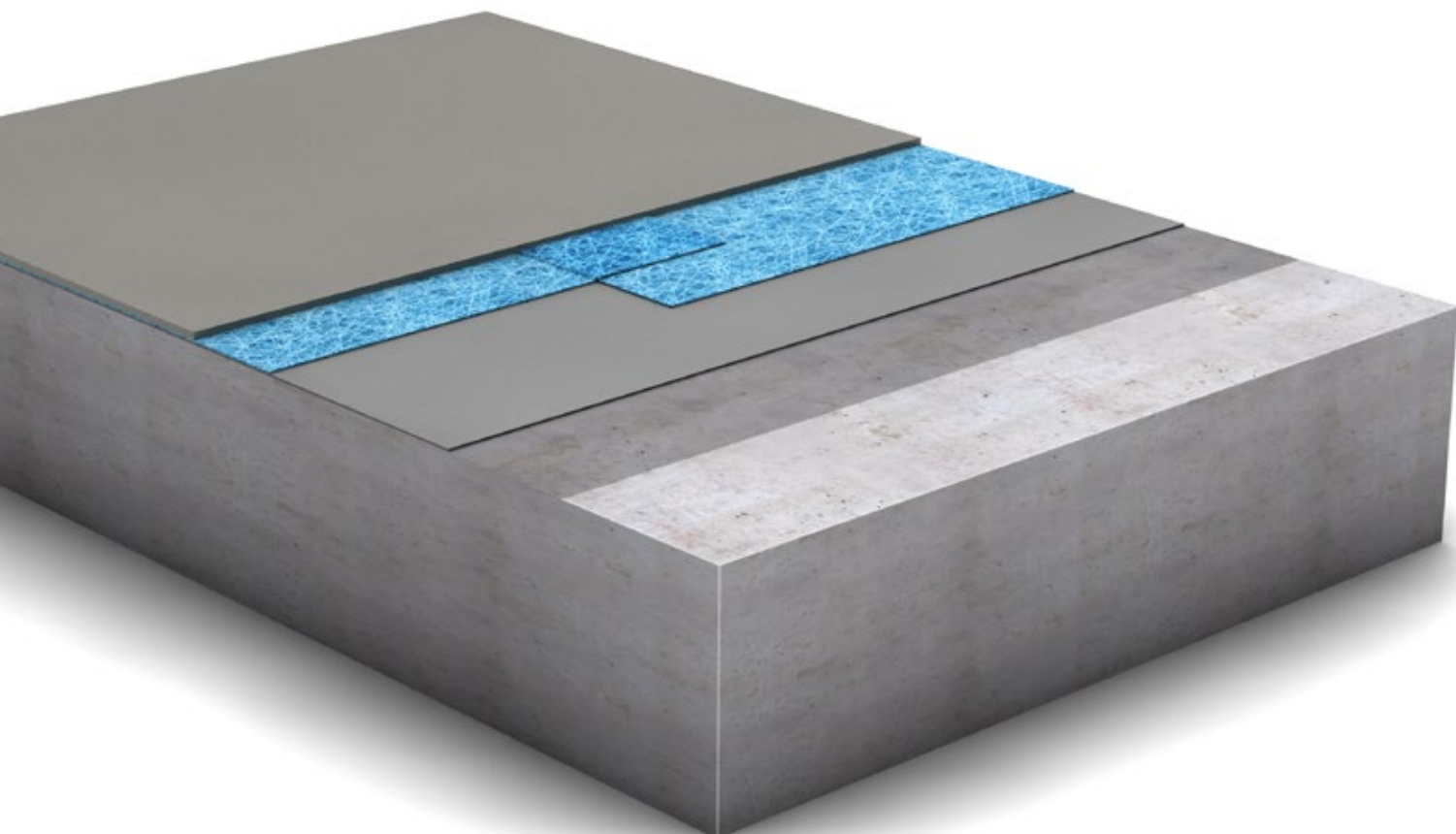

Grondering	MC-DUR 1177 WV-A	ca. 300 g/m ²
Afdichtingslaag	MC-DUR TopSpeed flex plus	ca. 1.250 g/m ²
Weefselvlies	MC-Floor Tex	110 g/m ²
Afdichtingslaag	MC-DUR TopSpeed flex plus	ca. 1.250 g/m ²

KZ= Kwartszand

Systeemopbouw

Opbouw conform DIN 18531

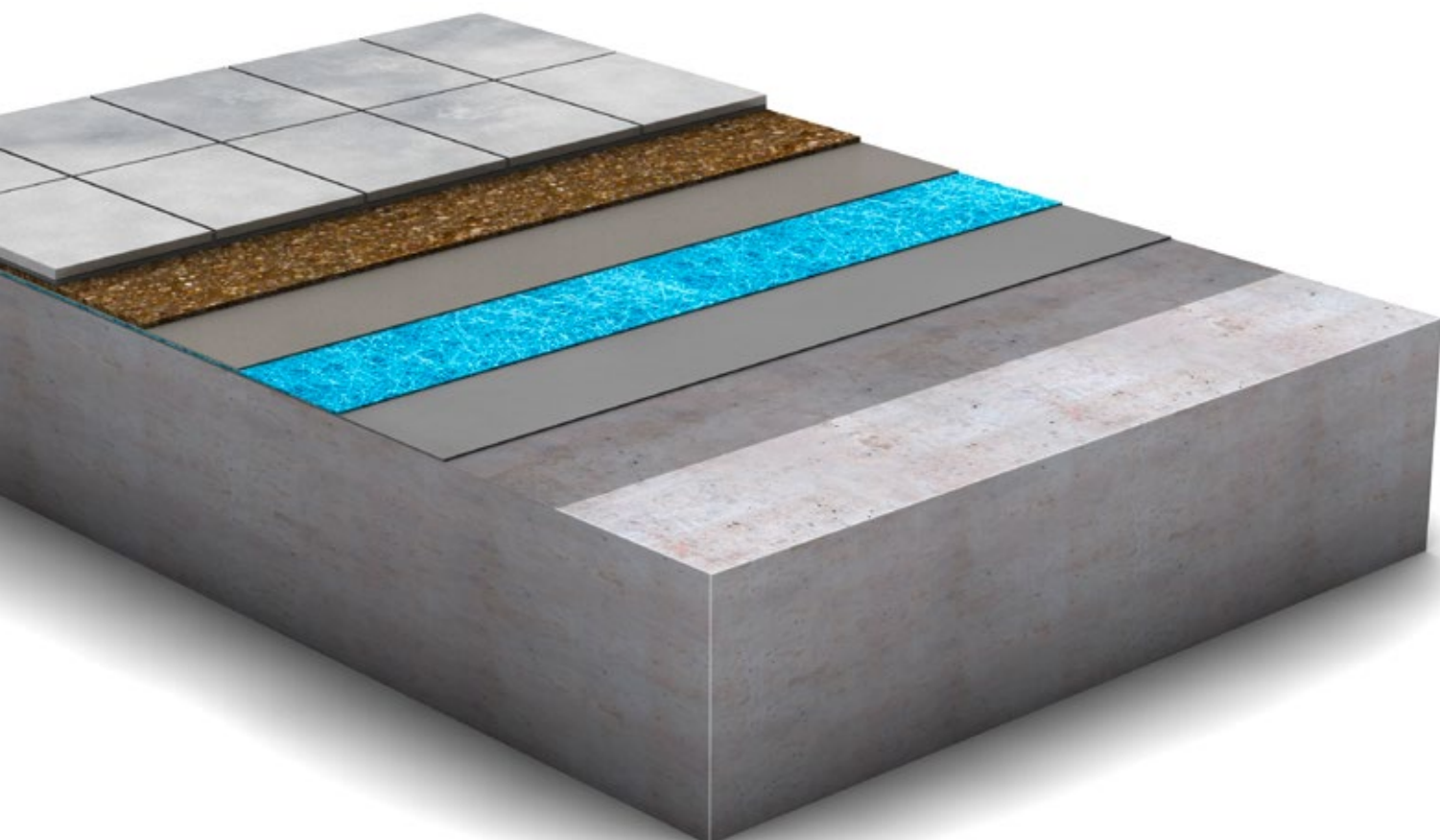

Grondering	MC-DUR 1177 WV-A	ca. 300 g/m ²
Afdichtingslaag	MC-DUR TopSpeed flex plus	ca. 1.250 g/m ²
Weefselvlies	MC-Floor Tex	110 g/m ²
Afdichtingslaag	MC-DUR TopSpeed flex plus	ca. 1.250 g/m ²
Instrooilaag	MC-DUR TopSpeed flex plus + KZ (volzat)	ca. 400 g/m ²

KZ = Kwarszand

Systemopbouw

Opbouw conform DIN 18531

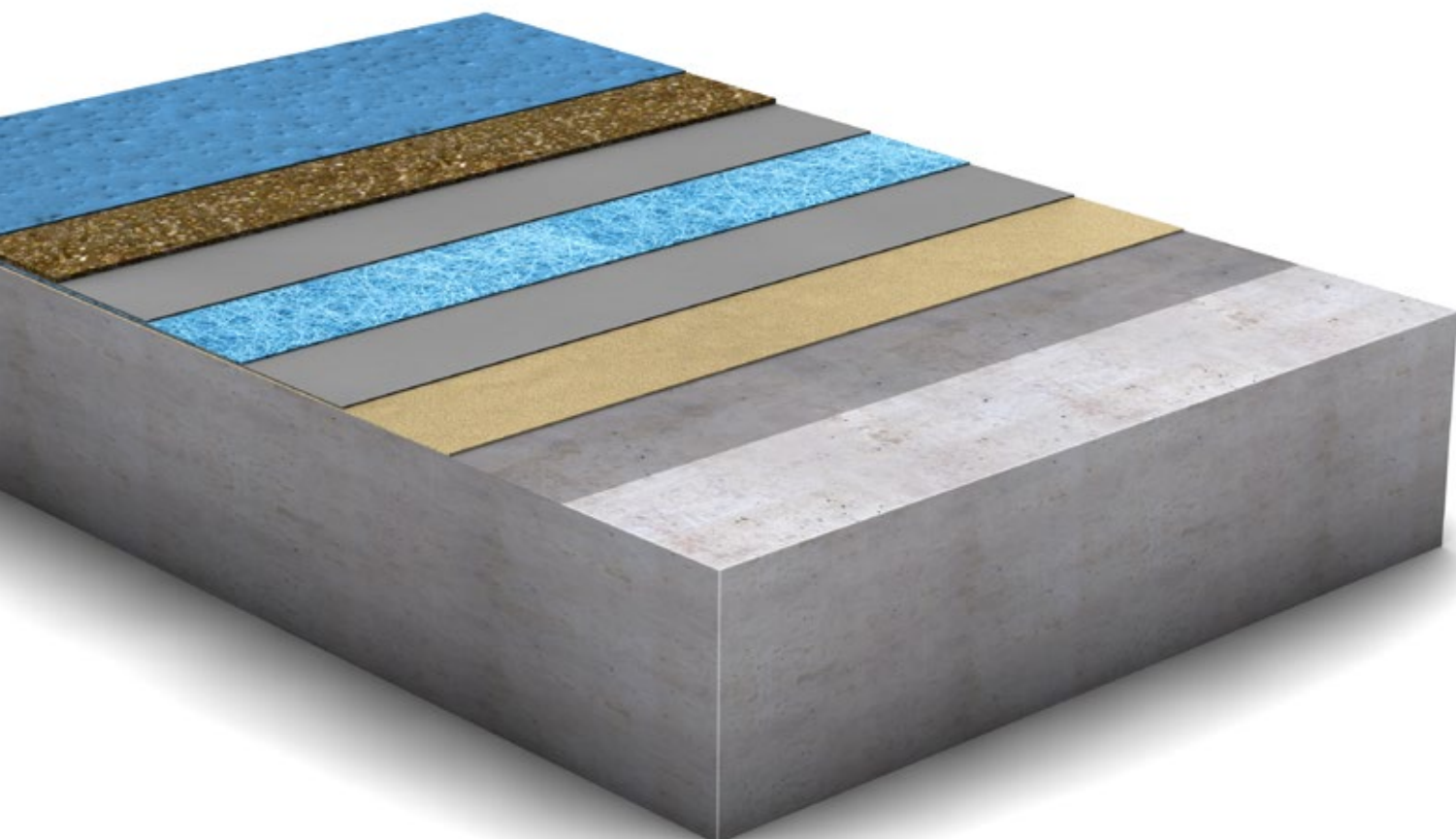

Grondering	MC-DUR 1177 WV-A	ca. 300 g/m ²
Schraaplaag	MC-DUR TopSpeed SC + KZ (1:1)	ca. 1.200 g/m ²
Afdichtingslaag	MC-DUR TopSpeed flex plus	ca. 1.250 g/m ²
Weefselvlies	MC-Floor Tex	110 g/m ²
Afdichtingslaag	MC-DUR TopSpeed flex plus	ca. 1.250 g/m ²
Instrooilaa	MC-DUR TopSpeed + KZ (volzat)	ca. 400 g/m ²
Verzegeling	MC-DUR TopSpeed	ca. 600 g/m ²

KZ = Kwartszand

Systeemopbouw

Opbouw conform DIN 18531

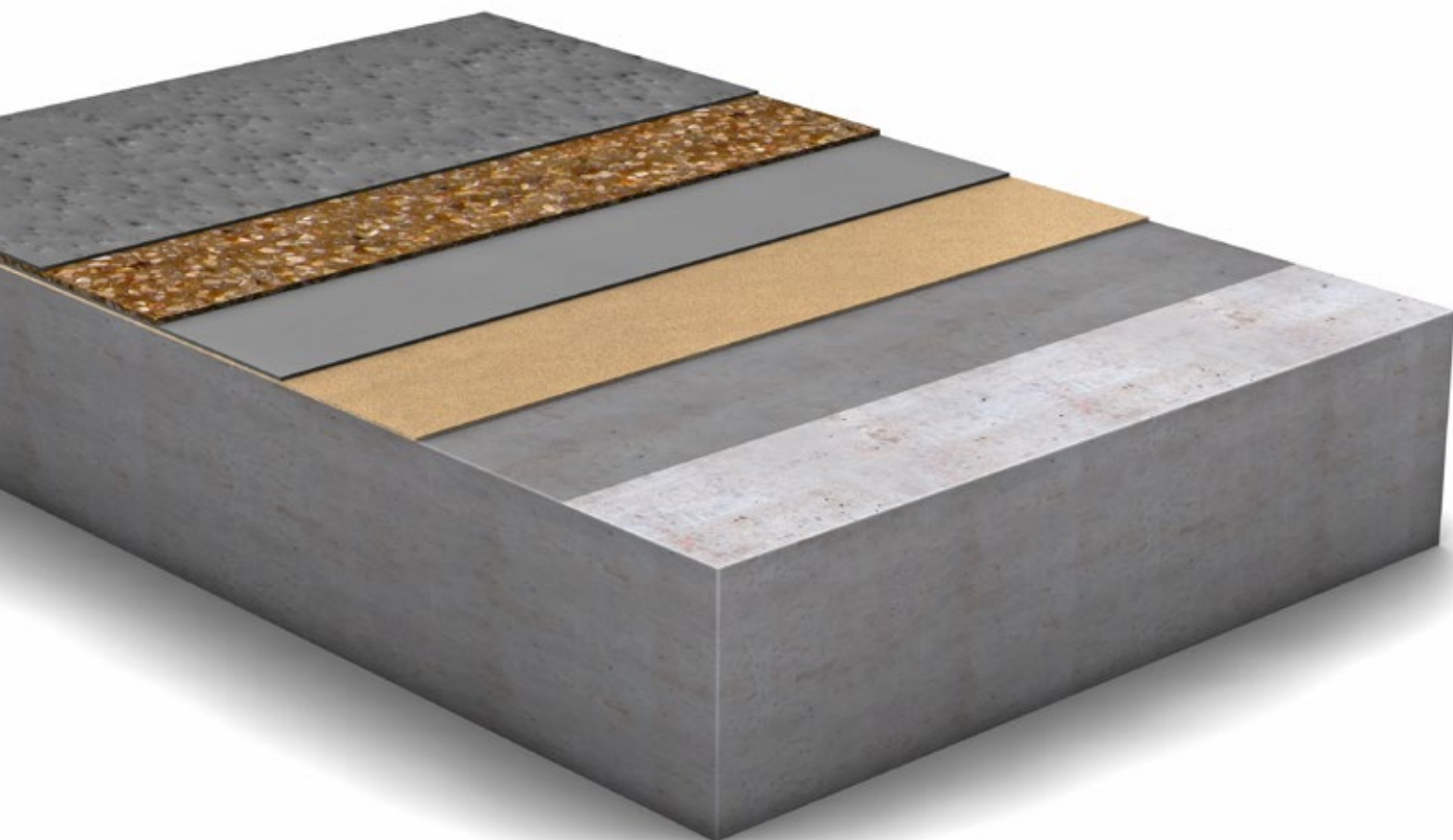







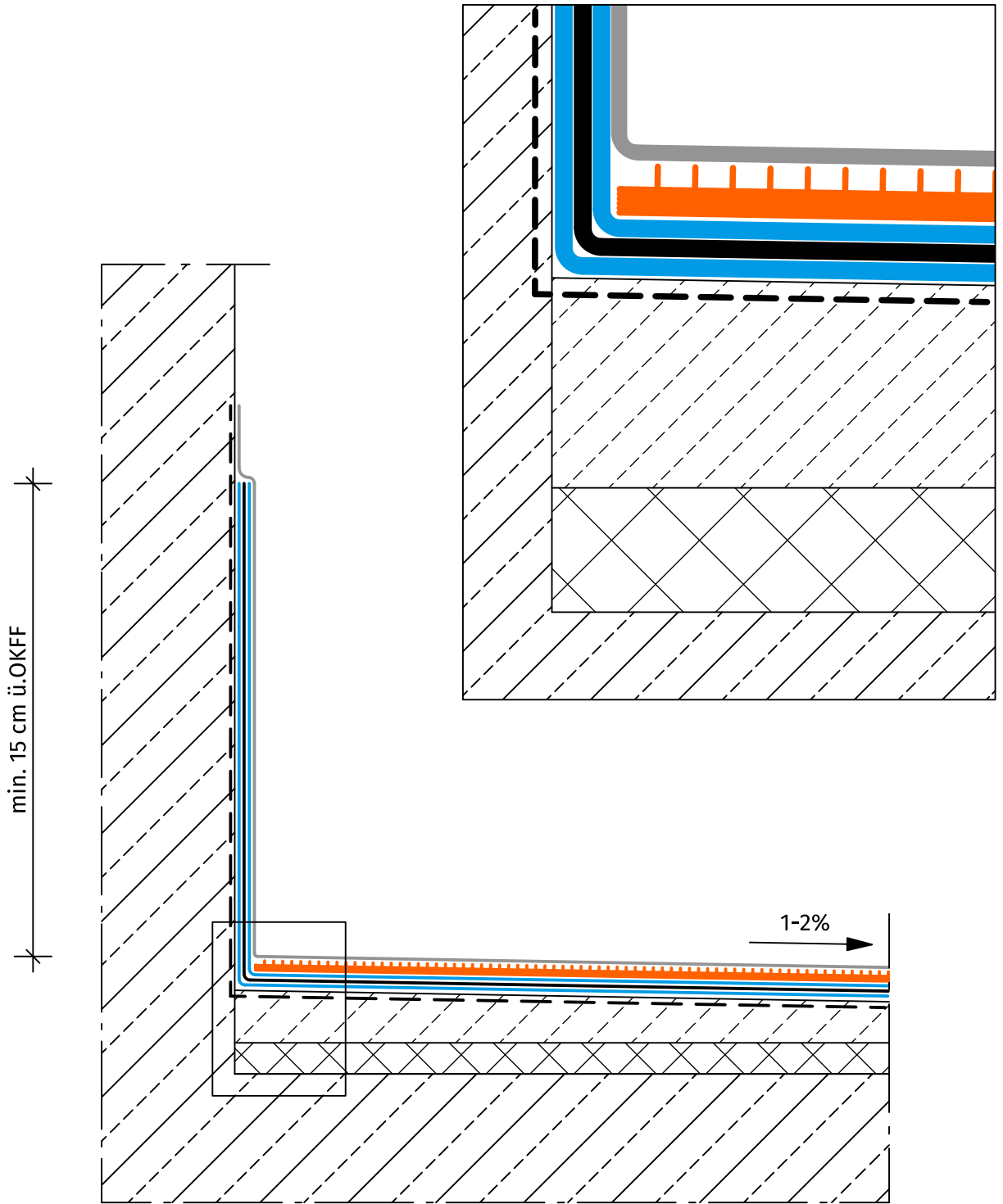

Grondering	MC-DUR TopSpeed SC	ca. 300 g/m ²
Schraaplaag	MC-DUR TopSpeed SC + KZ (1:1)	ca. 1.200 g/m ²
Afdichtingslaag	MC-DUR TopSpeed flex plus	ca. 1.000 g/m ²
Instrooilaag	MC-DUR TopSpeed + KZ (volzat)	ca. 400 g/m ²
Verzegeling	MC-DUR TopSpeed	ca. 600 g/m ²

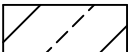
KZ = kwartszand

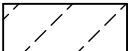
Afdichtingsdetails



Legende:







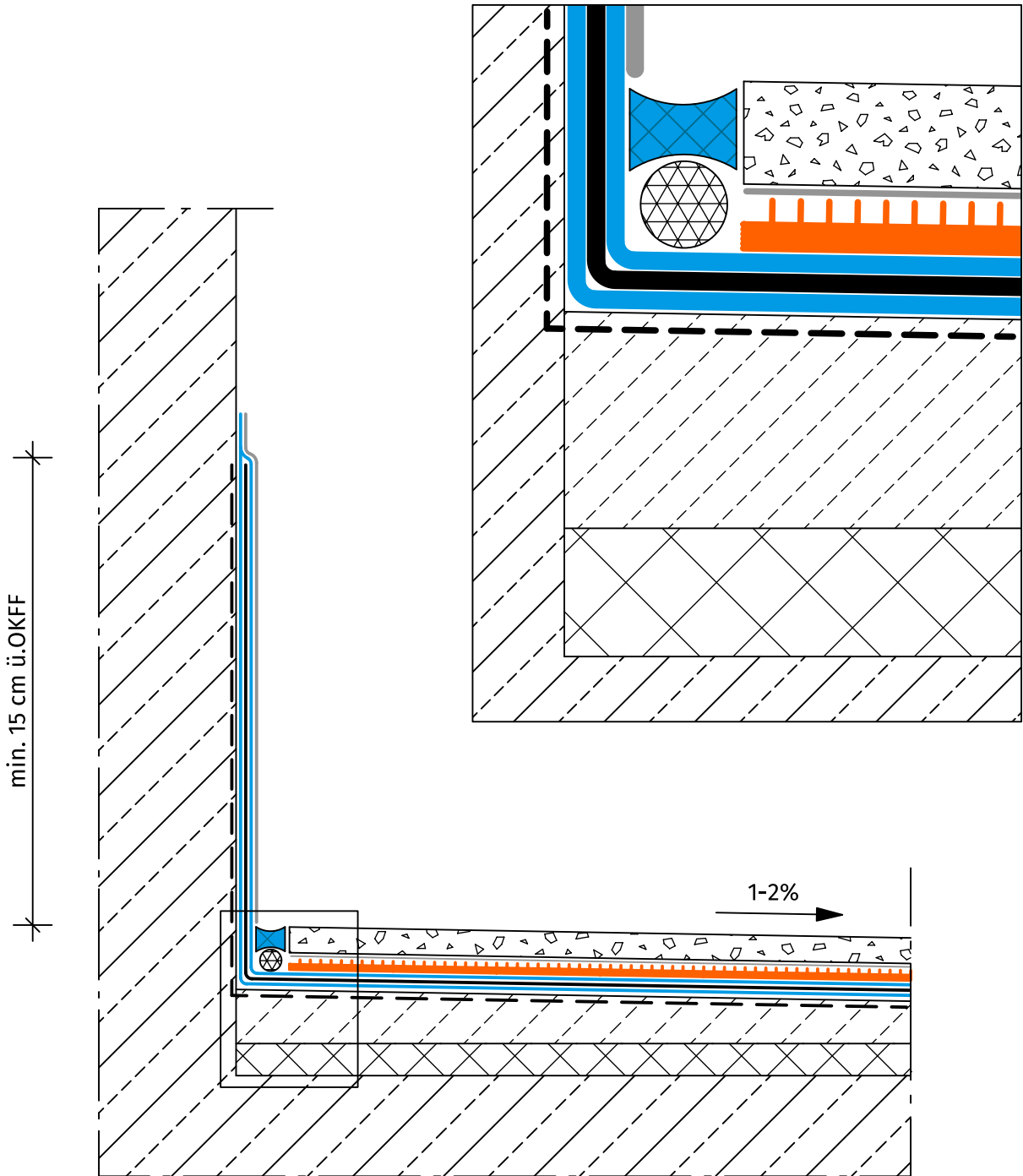

-  Untergrund
-  Dränplatte
-  Gefälleestrich
-  Grundierung
-  Dichtungsschicht
-  Gewebevlies
-  Verschleißschicht
-  Kopfversiegelung

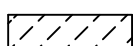
Afdichtingsdetail 01a:Vloer-wand-aansluiting

Grundierung	MC-DUR 1177 WV-A
Dichtungsschicht	MC-DUR TopSpeed flex plus
Gewebevlies	MC-Floor Tex
Verschleißschicht	MC-DUR TopSpeed + Quarzsand
Kopfversiegelung	MC-DUR TopSpeed



Legende:

-  Grundierung
-  Gefälleestrich
-  Elastischer Dichtstoff
-  Rundschnur
-  Fliesen
-  Dränplatte
-  Dichtungsschicht
-  Gewebvlies
-  Verkrallungsschicht
-  Fliesenkleber







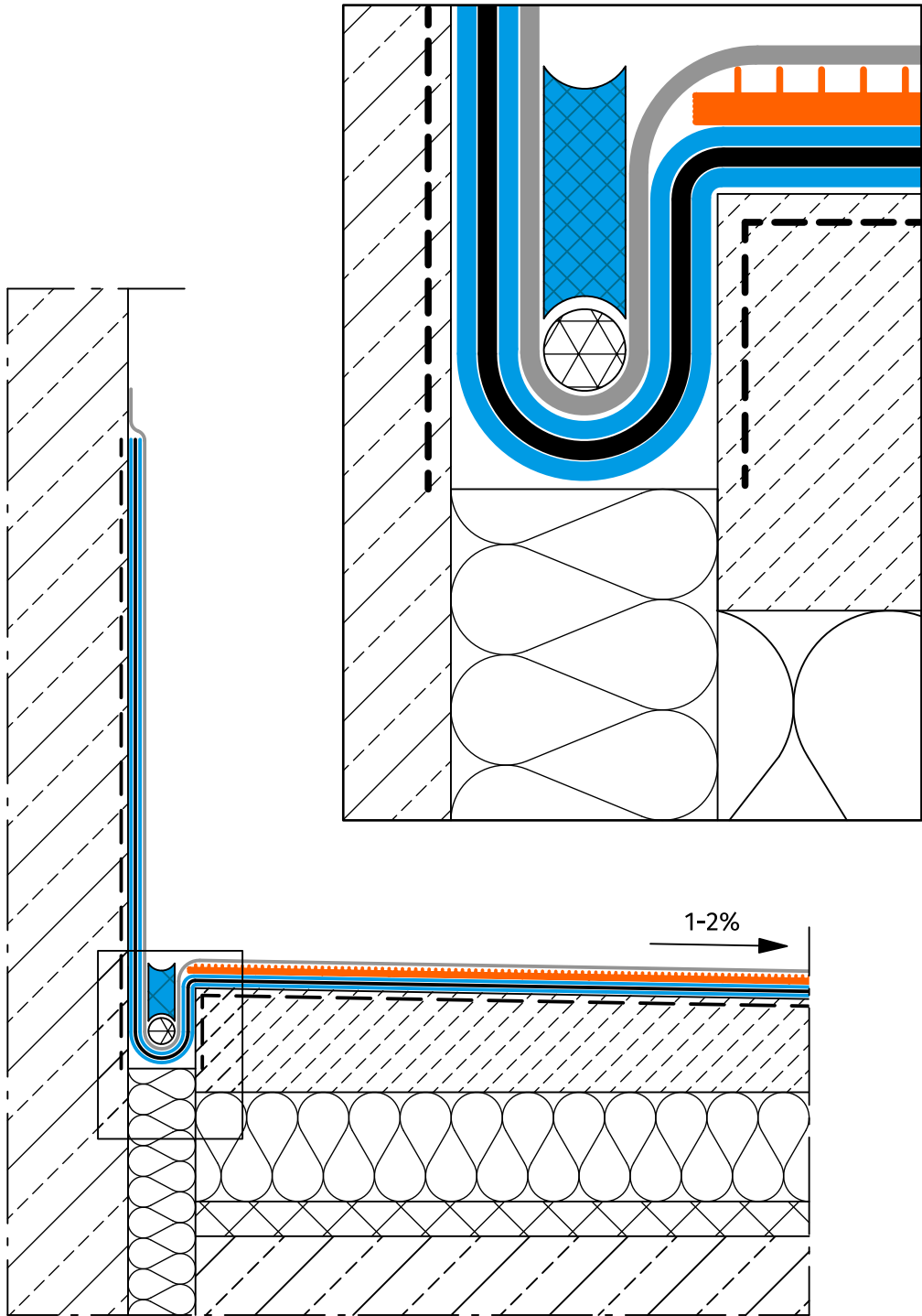

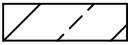

Afdichtingsdetail 01b: vloer-wand aansluiting met tegels

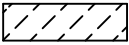
Grundierung	MC-DUR 1177 WV-A
Dichtungsschicht	MC-DUR TopSpeed flex plus
Gewebevlies	MC-Floor Tex
Elastischer Dichtstoff	Mycoflex 488 MS
Rundschnur	geschlossenzellige PE Rundschnur
Verkrallungsschicht	MC-DUR TopSpeed flex plus + Quarzsand
Fliesenkleber	je nach Material

min. 15 cm ü.OKFF



Legende:

-  Untergrund
-  Dränplatte
-  Gefälleestrich
-  Elastischer Dichtstoff
-  Rundschnur
-  Grundierung
-  Dichtungsschicht
-  Gewebvlies
-  Verschleißschicht
-  Kopfversiegelung







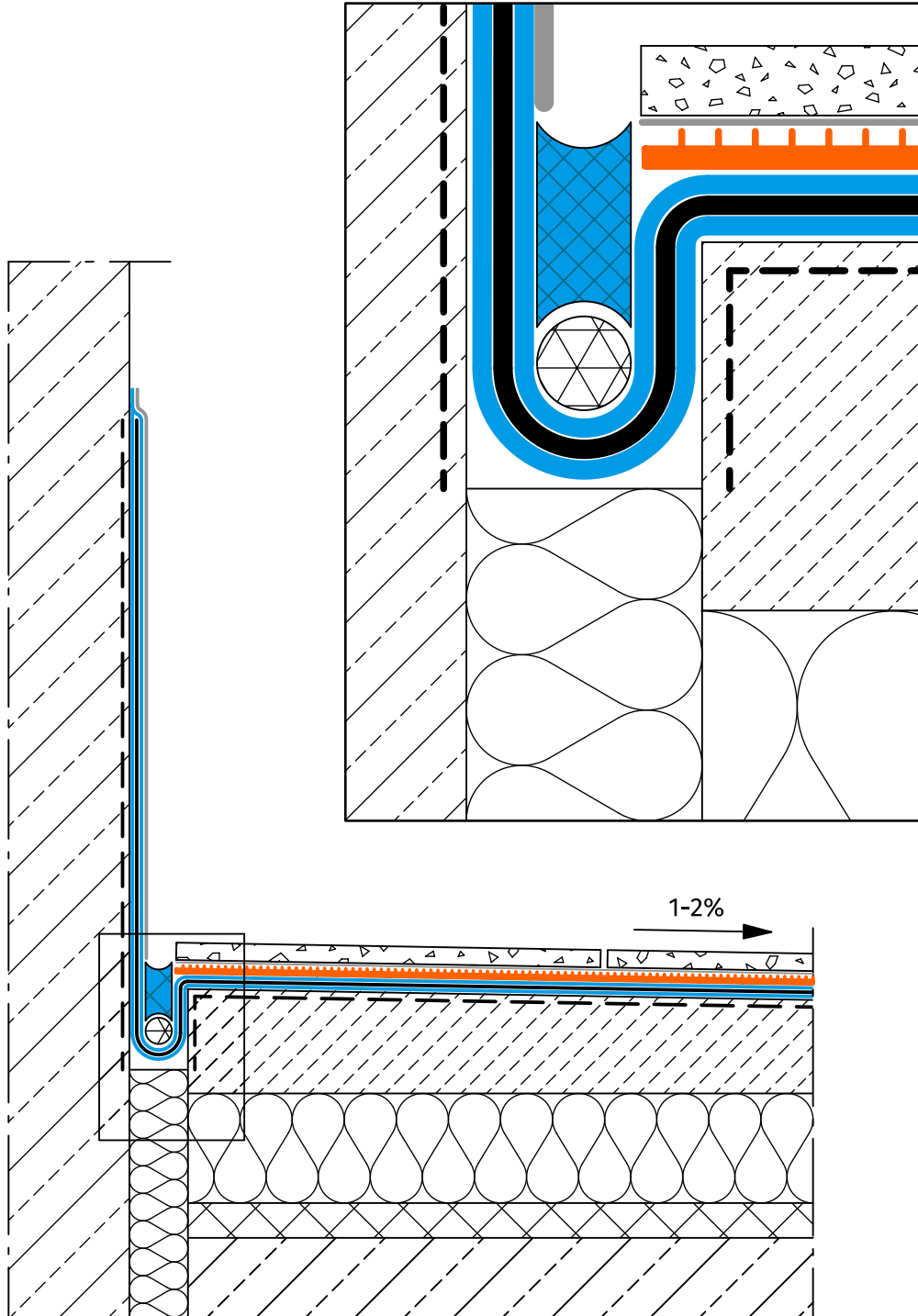

Afdichtungsdetail 02a: Isolatie

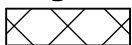
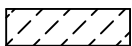
Grundierung	MC-DUR 1177 WV-A
Dichtungsschicht	MC-DUR TopSpeed flex plus
Gewebvlies	MC-Floor Tex
Elastischer Dichtstoff	Mycoflex 488 MS
Rundschnur	geschlossenzellige PE Rundschnur
Verschleißschicht	MC-DUR TopSpeed + Quarzsand
Kopfversiegelung	MC-DUR TopSpeed

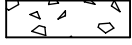
min. 15 cm ü.OKFF

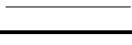

Legende:

-  Dränplatte
-  Gefälleestrich
-  Elastischer Dichtstoff
-  Rundschnur
-  Fliesen
-  Grundierung
-  Dichtungsschicht
-  Gewebevlies
-  Verkrallungsschicht
-  Fliesenkleber







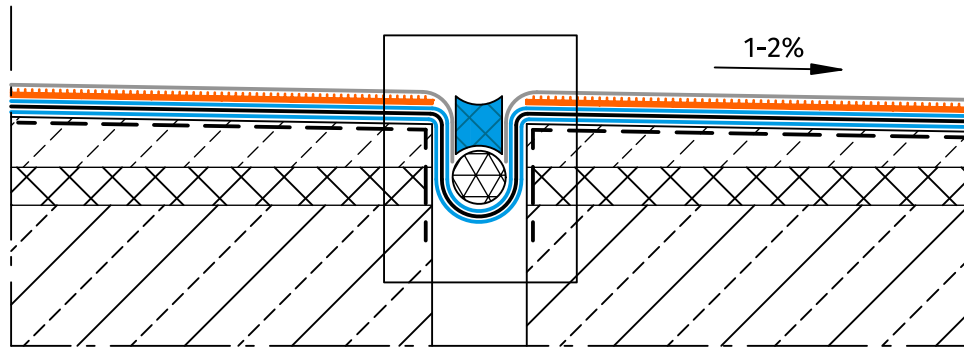
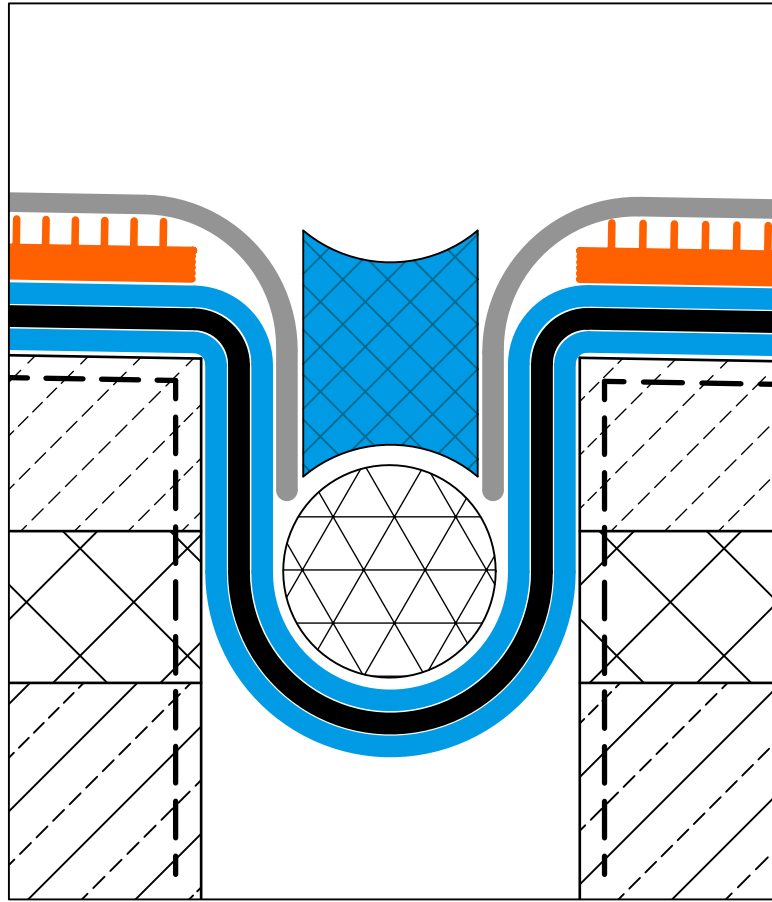

Afdichtungsdetail 02b: isolatie met tegels

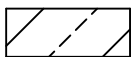
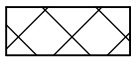
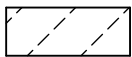
Grundierung	MC-DUR 1177 WV-A
Dichtungsschicht	MC-DUR TopSpeed flex plus
Gewebevlies	MC-Floor Tex
Elastischer Dichtstoff	Mycoflex 488 MS
Rundschnur	geschlossenzellige PE Rundschnur
Verkrallungsschicht	MC-DUR TopSpeed flex plus + Quarzsand
Fliesenkleber	je nach Material

03a



Legende:







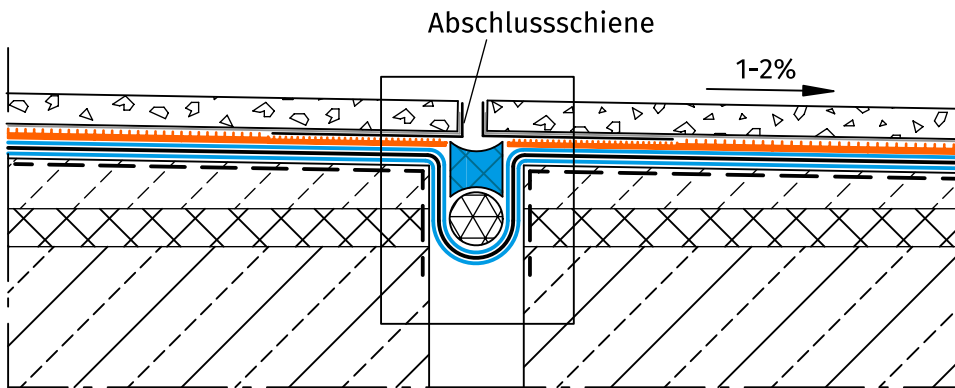
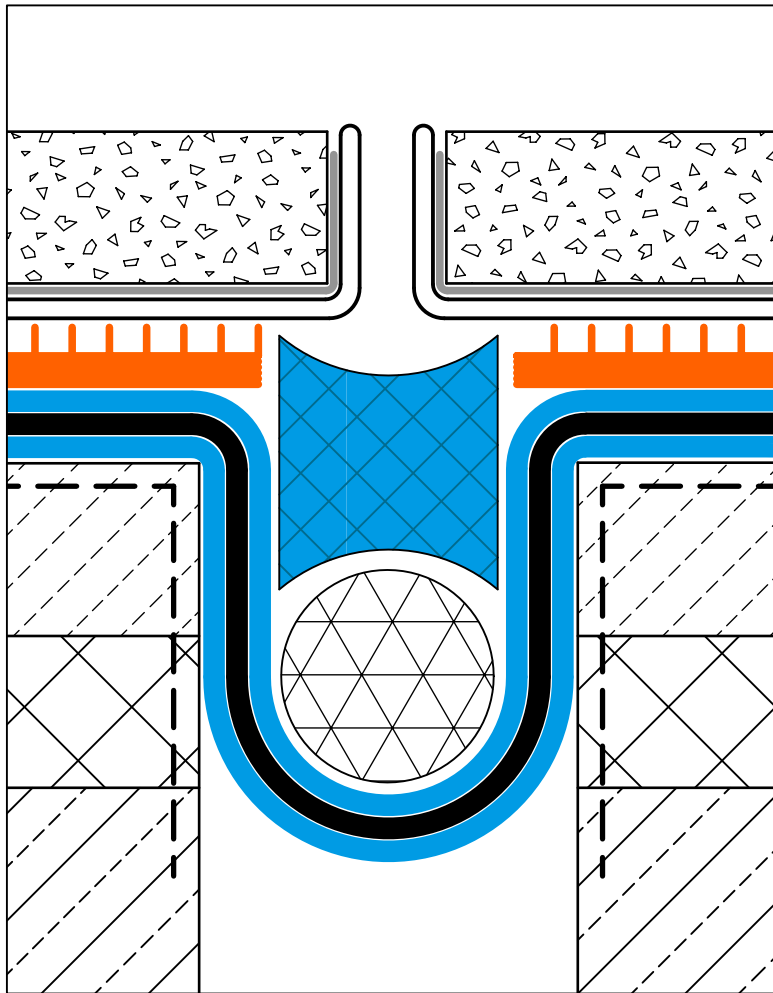

-  Untergrund
-  Dränplatte
-  Gefälleestrich
-  Grundierung
-  Dichtungsschicht
-  Gewebevlies
-  Verschleißschicht
-  Kopfversiegelung
-  Rundschnur
-  Elastischer Dichtstoff

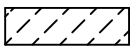
Afdichtingsdetail 03a: stootvoegen

Grundierung	MC-DUR 1177 WV-A
Dichtungsschicht	MC-DUR TopSpeed flex plus
Gewebevlies	MC-Floor Tex
Elastischer Dichtstoff	Mycoflex 488 MS
Rundschnur	geschlossenzellige PE Rundschnur
Verschleißschicht	MC-DUR TopSpeed + Quarzsand
Kopfversiegelung	MC-DUR TopSpeed

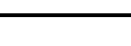

Legende:

-  Dränplatte
-  Gefälleestrich
-  Elastischer Dichtstoff
-  Rundschnur
-  Fliesen
-  Grundierung
-  Dichtungsschicht
-  Gewebvlies
-  Verkrallungsschicht
-  Fliesenkleber







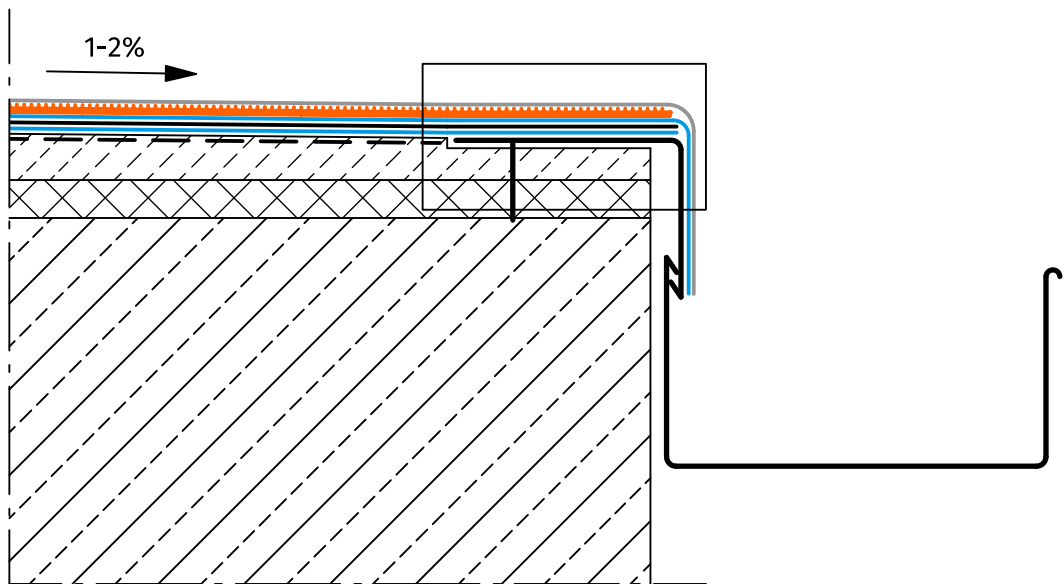
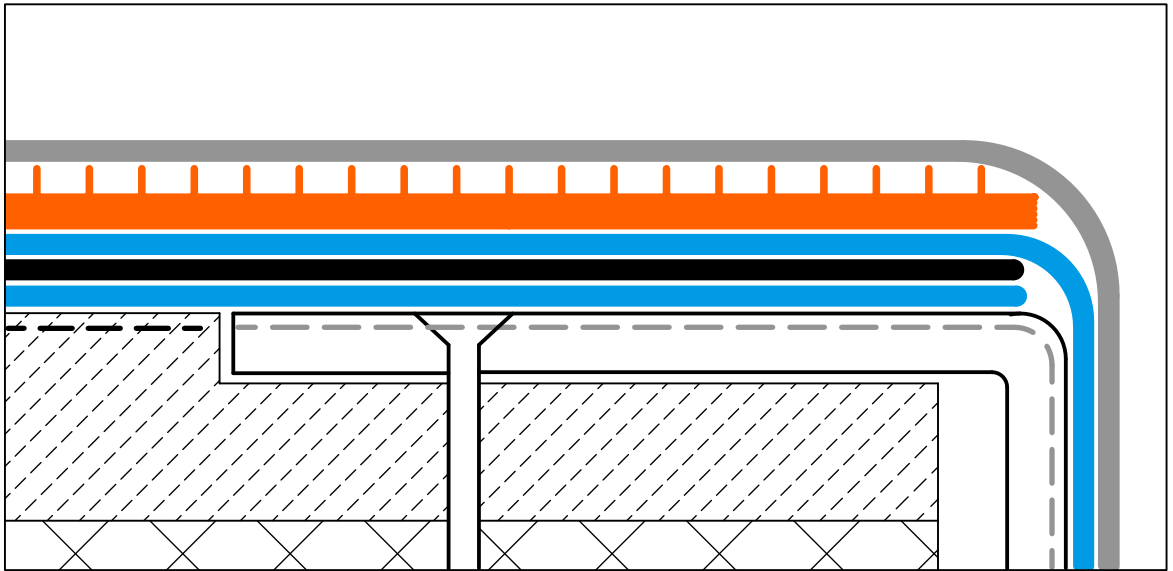

Afdichtungsdetail 03b: stootvoegen met tegels

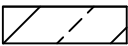
Grundierung	MC-DUR 1177 WV-A
Dichtungsschicht	MC-DUR TopSpeed flex plus
Gewebevlies	MC-Floor Tex
Elastischer Dichtstoff	Mycoflex 488 MS
Rundschnur	geschlossenzellige PE Rundschnur
Verkrallungsschicht	MC-DUR TopSpeed flex plus + Quarzsand
Fliesenkleber	je nach Material

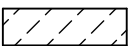
04a



Legende:

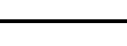



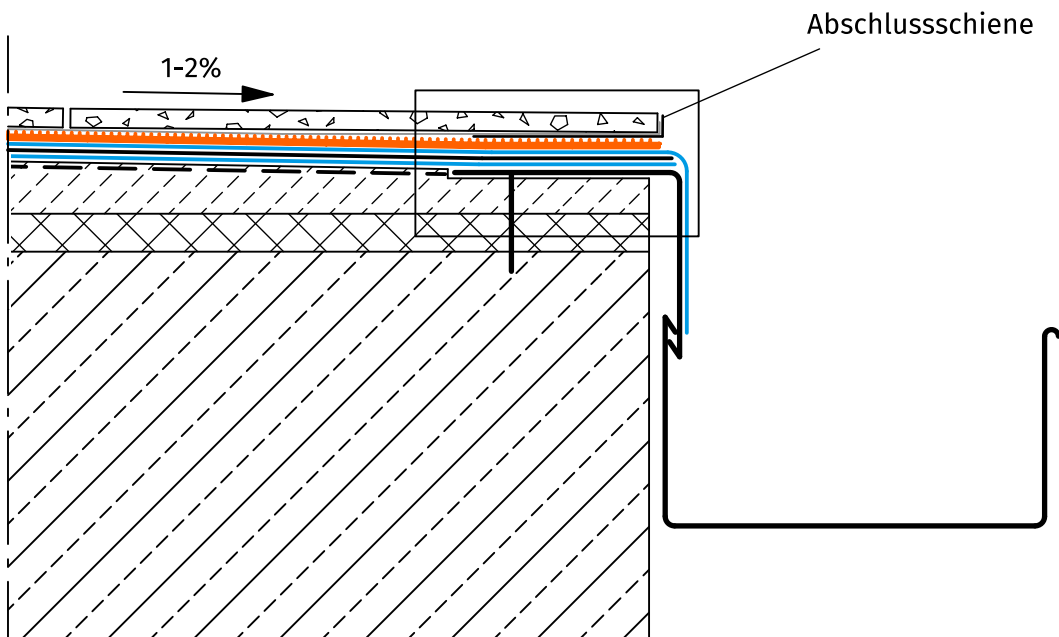
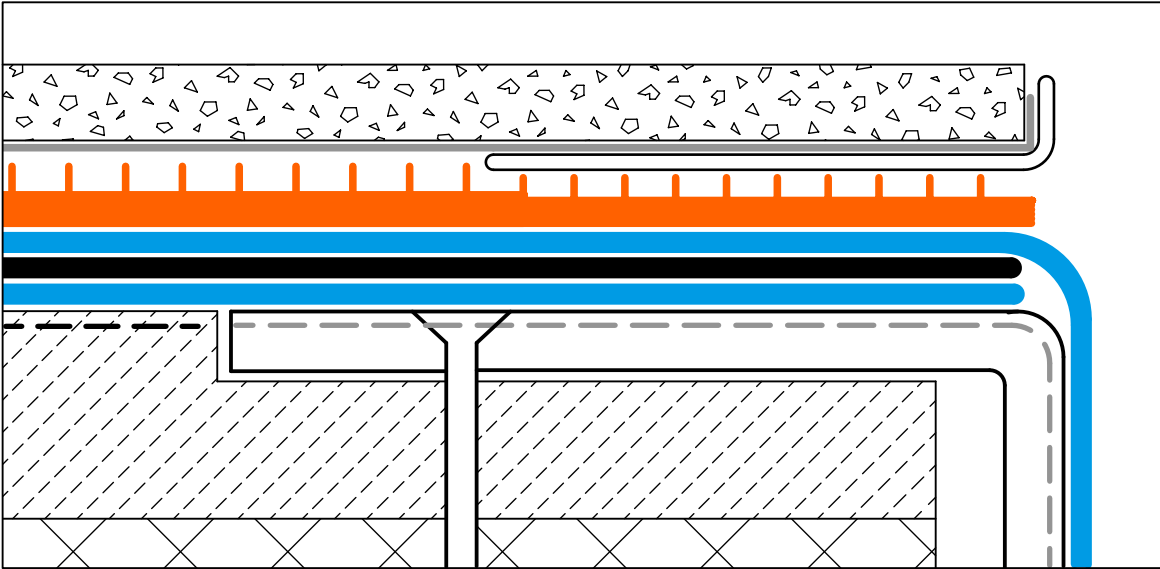

-  Untergrund
-  Dränplatte
-  Gefälleestrich
-  Grundierung I
-  Grundierung II
-  Dichtungsschicht
-  Gewebevlies
-  Verschleißschicht
-  Kopfversiegelung

Afdichtingsdetail 04a: Randafwerking met goot

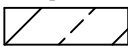
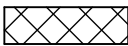
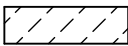
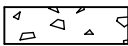
Grundierung I	MC-DUR 1177 WV-A
Grundierung II	je nach Material (siehe Primerliste)
Dichtungsschicht	MC-DUR TopSpeed flex plus
Gewebevlies	MC-Floor Tex
Verschleißschicht	MC-DUR TopSpeed + Quarzsand
Kopfversiegelung	MC-DUR TopSpeed

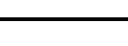

Legende:







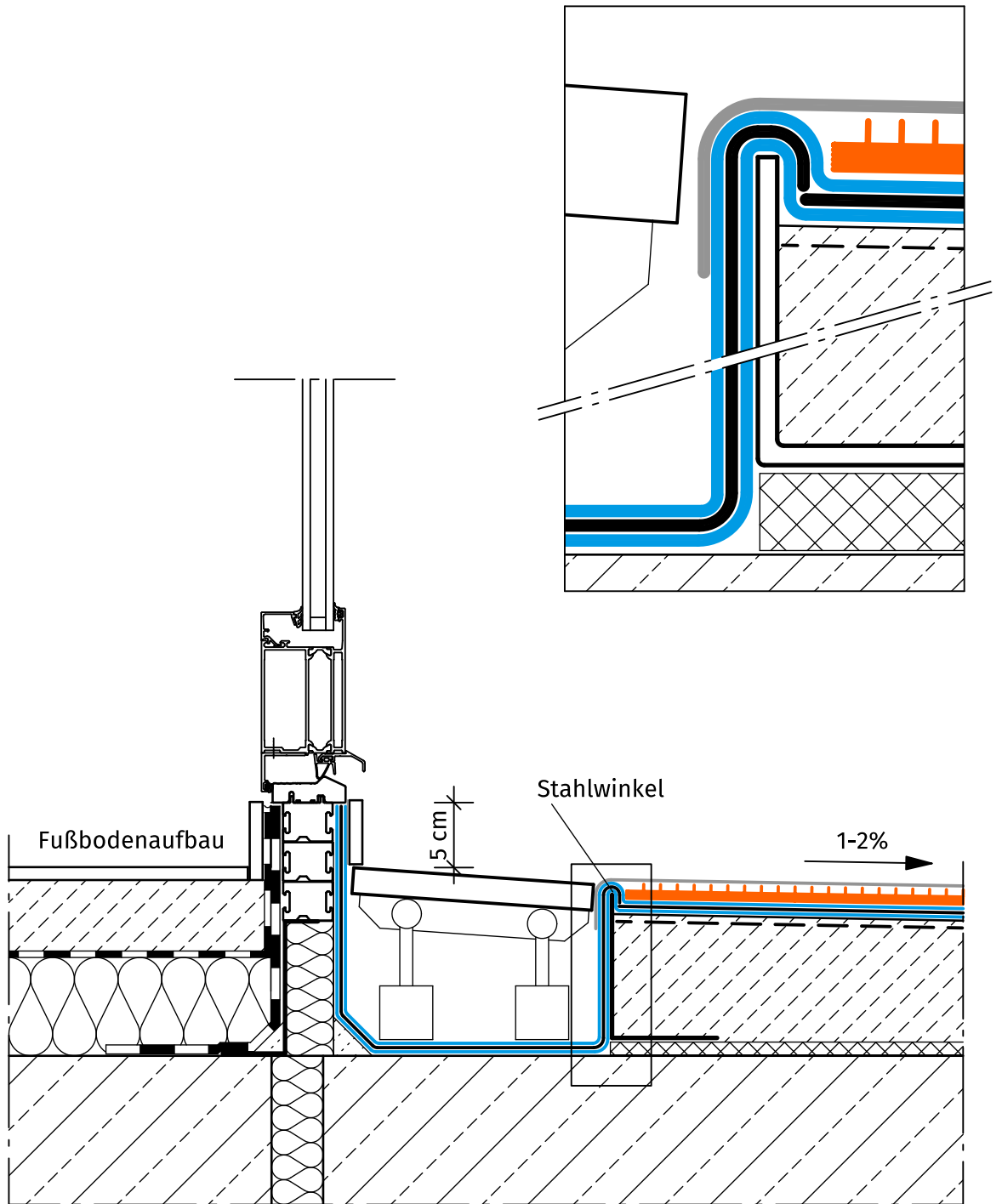

-  Untergrund
-  Dränplatte
-  Gefälleestrich
-  Fliesen
-  Grundierung I
-  Grundierung II
-  Dichtungsschicht
-  Gewebelies
-  Verkrallungsschicht
-  Fliesenkleber

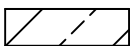
Afdichtingsdetail 04b: Randafwerking met goot en tegels

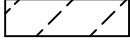
Grundierung I	MC-DUR 1177 WV-A
Grundierung II	je nach Material (siehe Primerliste)
Dichtungsschicht	MC-DUR TopSpeed flex plus
Gewebelies	MC-Floor Tex
Verkrallungsschicht	MC-DUR TopSpeed flex plus + Quarzsand
Fliesenkleber	je nach Material



Legende:







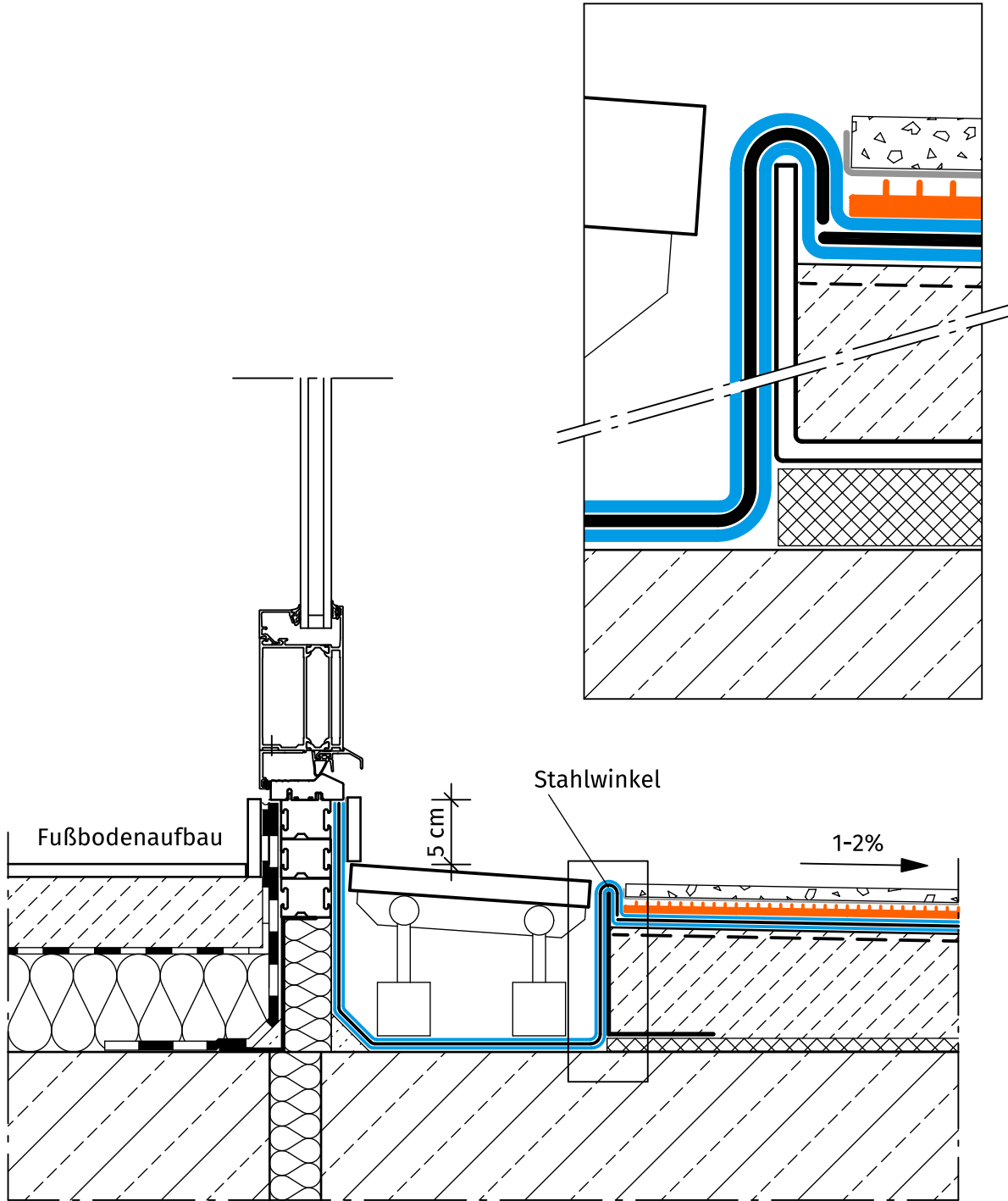

-  Untergrund
-  Dränplatte
-  Gefälleestrich
-  Grundierung I
-  Grundierung II
-  Dichtungsschicht
-  Gewebevlies
-  Verschleißschicht
-  Kopfversiegelung

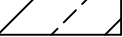
Afdichtingsdetail 05a:deuraansluiting 5 cm

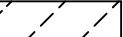
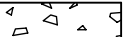
Grundierung I	MC-DUR 1177 WV-A
Grundierung II	je nach Material (siehe Primerliste)
Dichtungsschicht	MC-DUR TopSpeed flex plus
Gewebevlies	MC-Floor Tex
Verschleißschicht	MC-DUR TopSpeed + Quarzsand
Kopfversiegelung	MC-DUR TopSpeed



Legende:

-  Untergrund
-  Dränplatte
-  Gefälleestrich
-  Fliesen
-  Grundierung I
-  Grundierung II
-  Dichtungsschicht
-  Gewebevlies
-  Verkrallungsschicht
-  Fliesenkleber







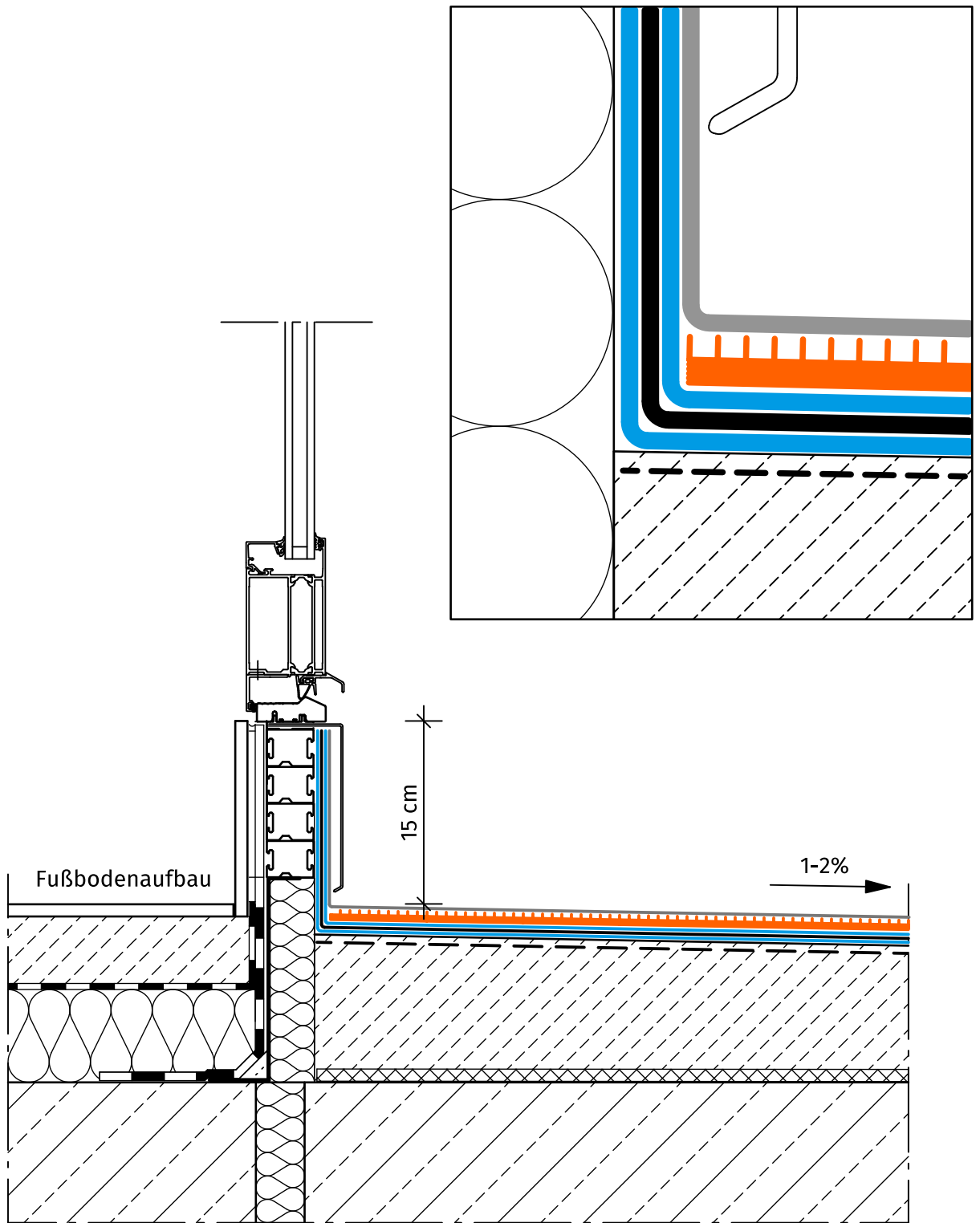

Afdichtingsdetail 05a: deuraansluiting 5 cm met tegels

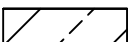
Grundierung I	MC-DUR 1177 WV-A
Grundierung II	je nach Material (siehe Primerliste)
Dichtungsschicht	MC-DUR TopSpeed flex plus
Gewebevlies	MC-Floor Tex
Verkrallungsschicht	MC-DUR TopSpeed flex plus + Quarzsand
Fliesenkleber	je nach Material

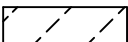
06a



Legende:

-  Untergrund
-  Dränplatte
-  Gefälleestrich
-  Grundierung
-  Dichtungsschicht
-  Gewebevlies
-  Verschleißschicht
-  Kopfversiegelung

Afdichtingsdetail 06a:deuraansluiting 15 cm

Grundierung	MC-DUR 1177 WV-A
Dichtungsschicht	MC-DUR TopSpeed flex plus
Gewebevlies	MC-Floor Tex
Verschleißschicht	MC-DUR TopSpeed + Quarzsand
Kopfversiegelung	MC-DUR TopSpeed

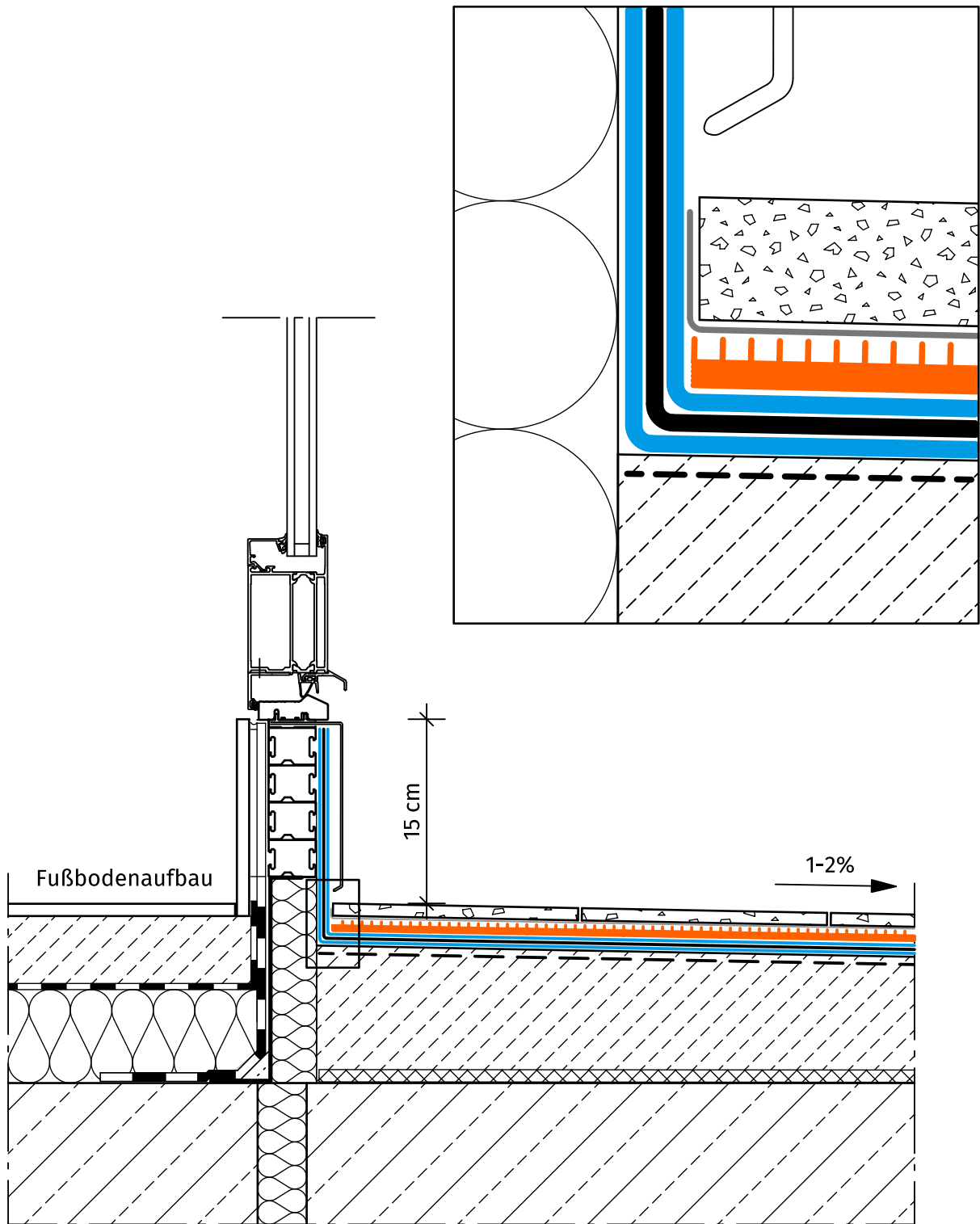

Legende:

-  Untergrund
-  Dränplatte
-  Gefälleestrich
-  Fliesen
-  Grundierung
-  Dichtungsschicht
-  Gewebevlies
-  Verkrallungsschicht
-  Fliesenkleber







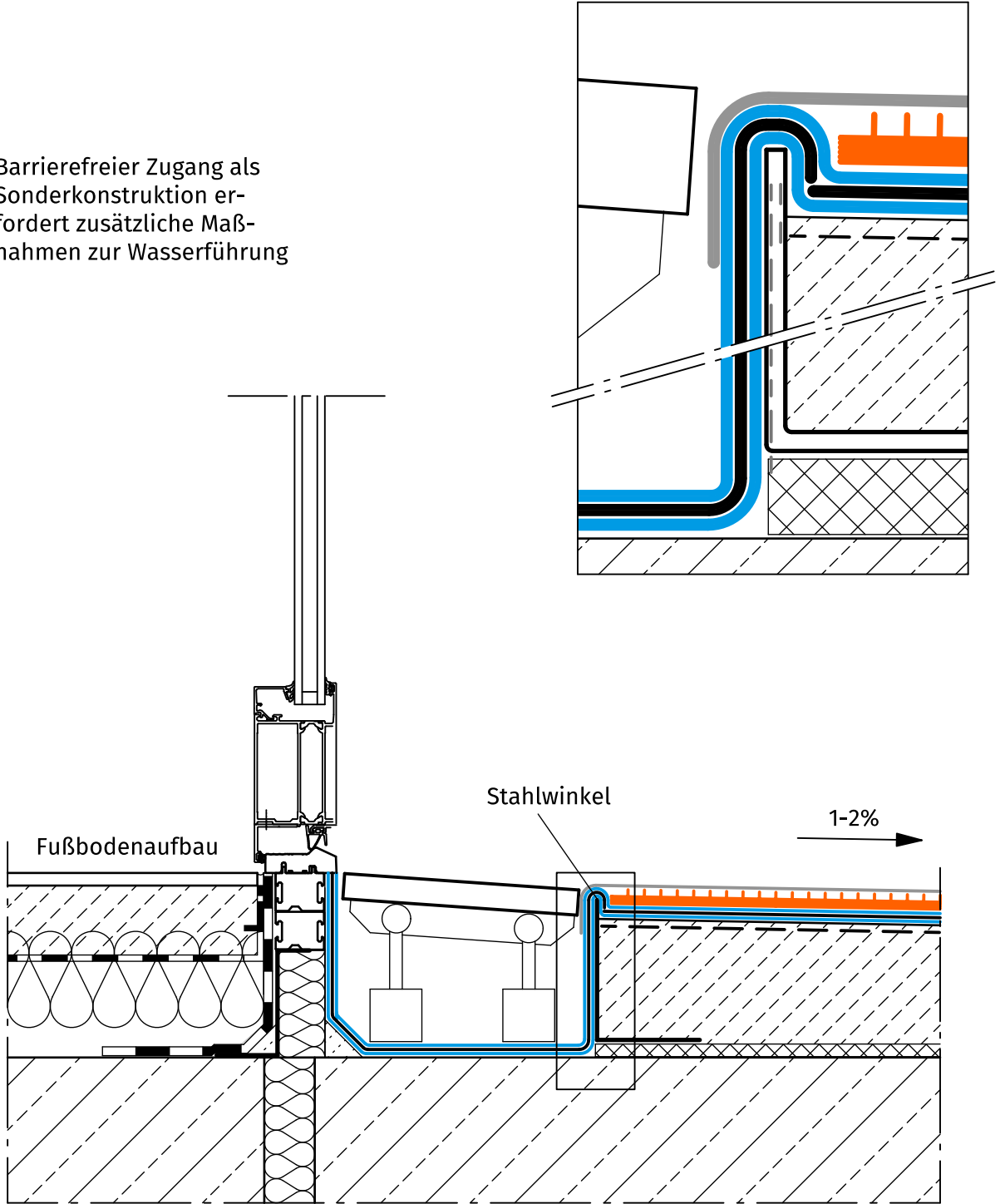

Afdichtingsdetail 06b: Deuraansluiting 15 cm met tegels

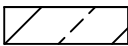
Grundierung	MC-DUR 1177 WV-A
Dichtungsschicht	MC-DUR TopSpeed flex plus
Gewebevlies	MC-Floor Tex
Verkrallungsschicht	MC-DUR TopSpeed flex plus + Quarzsand
Fliesenkleber	je nach Material

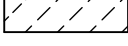
Barrierefreier Zugang als Sonderkonstruktion erfordert zusätzliche Maßnahmen zur Wasserführung



Legende:

-  Untergrund
-  Dränplatte
-  Gefälleestrich
-  Grundierung I
-  Grundierung II
-  Dichtungsschicht
-  Gewebevlies
-  Verschleißschicht
- Kopfversiegelung

Afdichtingsdetail 07a:Barrièrevrije deuraansluiting

Grundierung I	MC-DUR 1177 WV-A
Grundierung II	je nach Material (siehe Primerliste)
Dichtungsschicht	MC-DUR TopSpeed flex plus
Gewebevlies	MC-Floor Tex
Verschleißschicht	MC-DUR TopSpeed + Quarzsand
Kopfversiegelung	MC-DUR TopSpeed

Barrierefreier Zugang als Sonderkonstruktion erfordert zusätzliche Maßnahmen zur Wasserführung

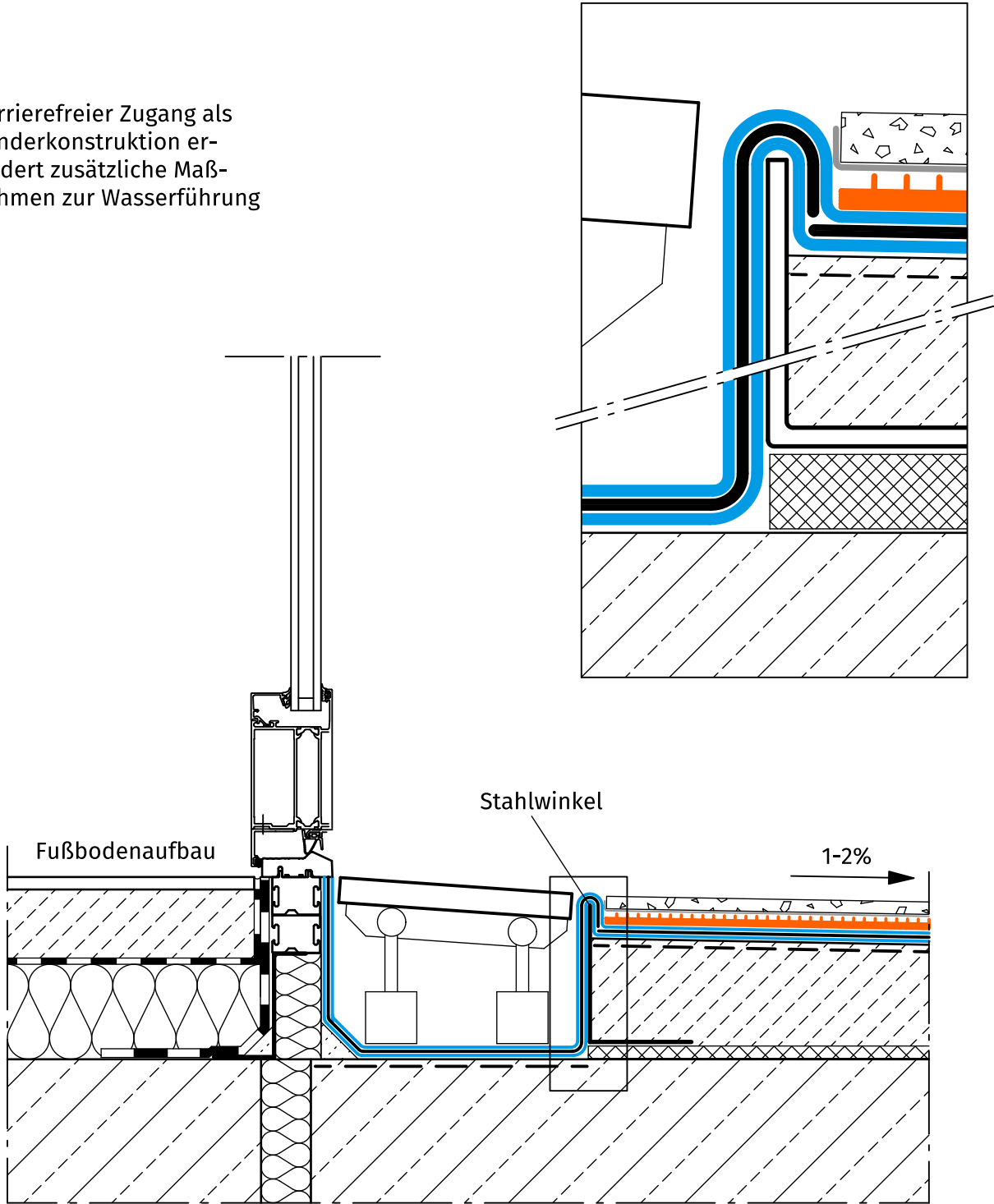

Legende:



- Untergrund
- Dränplatte
- Gefälleestrich
- Grundierung I
- Grundierung II
- Dichtungsschicht
- Gewebevlies
- Verschleißschicht
- Fliesenkleber

Afdichtungsdetail 07b: Barrierevrije deuraansluiting met tegels

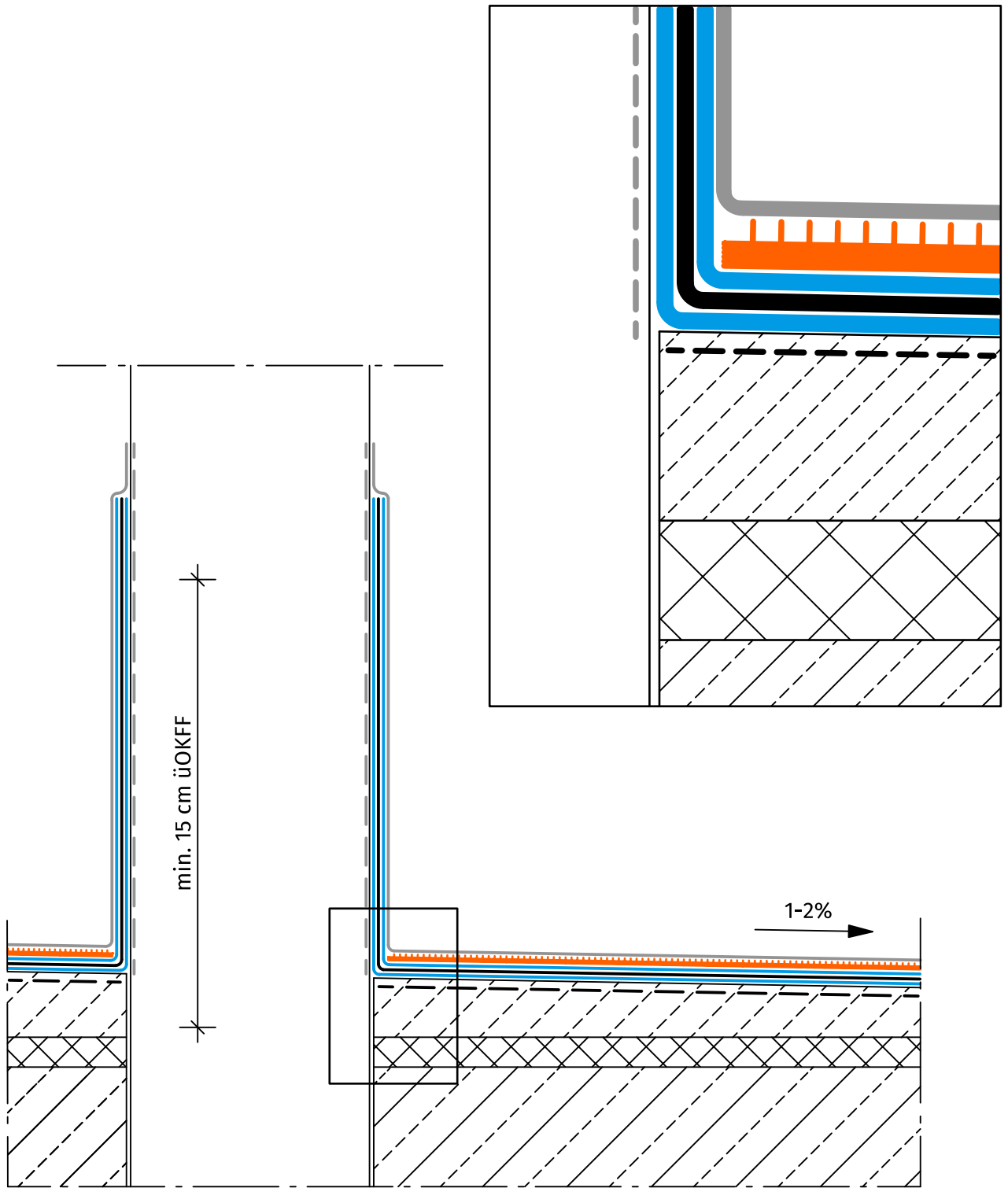
Grundierung I	MC-DUR 1177 WV-A
Grundierung II	je nach Material (siehe Primerliste)
Dichtungsschicht	MC-DUR TopSpeed flex plus
Gewebevlies	MC-Floor Tex
Verschleißschicht	MC-DUR TopSpeed flex plus + Quarzsand
Fliesenkleber	je nach Material

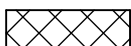

Legende:

-  Untergrund
-  Dränplatte
-  Gefälleestrich
-  Grundierung I
-  Grundierung II
-  Dichtungsschicht
-  Gewebevlies
-  Verschleißschicht
-  Kopfversiegelung

Afdichtungsdetail 08a: buisdoorvoer

Grundierung I	MC-DUR 1177 WV-A
Grundierung II	je nach Material (siehe Primerliste)
Dichtungsschicht	MC-DUR TopSpeed flex plus
Gewebevlies	MC-Floor Tex
Verschleißschicht	MC-DUR TopSpeed + Quarzsand
Kopfversiegelung	MC-DUR TopSpeed

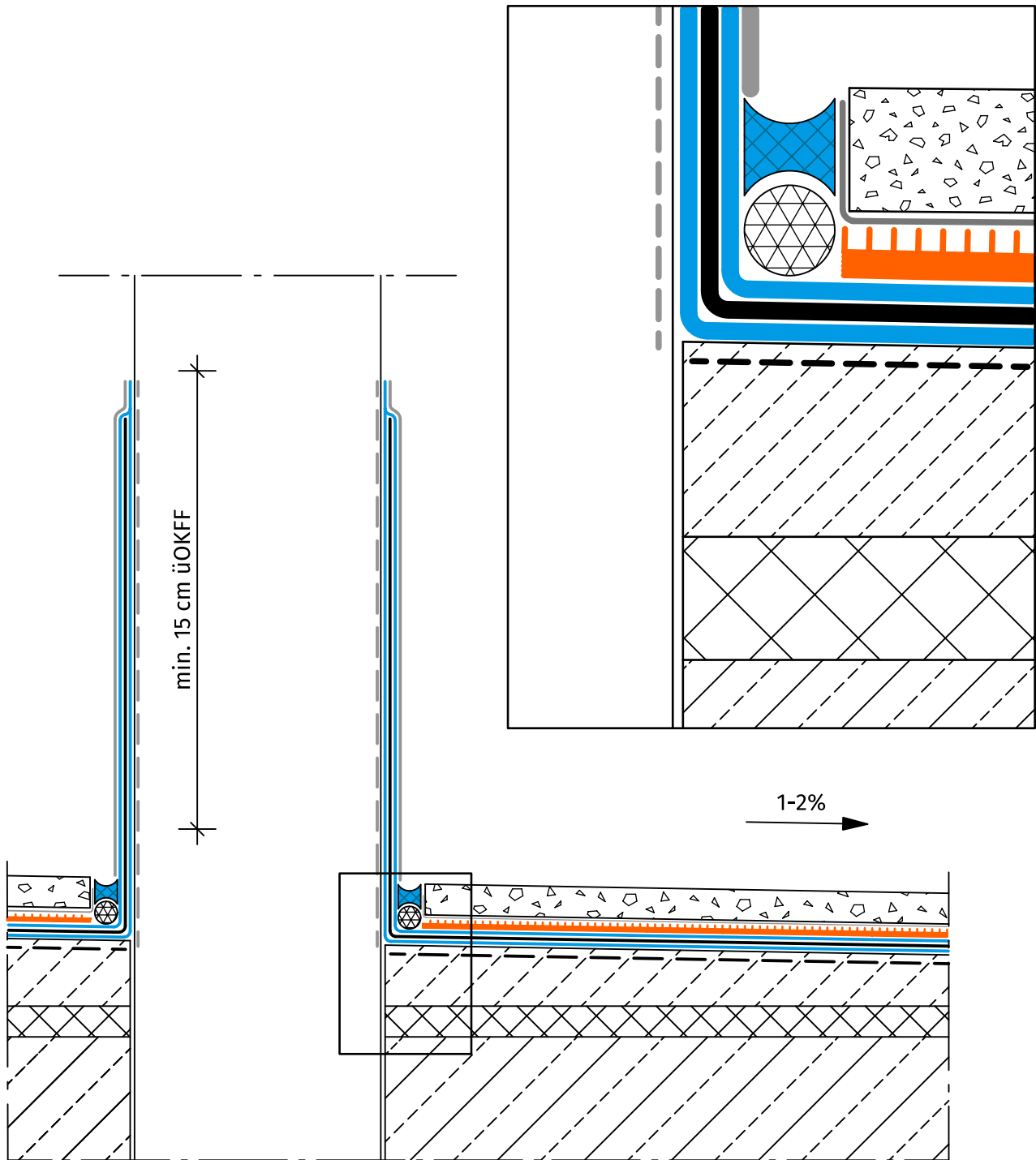

Legende:

-  Untergrund
-  Dränplatte
-  Gefälleestrich
-  Fliesen
-  Elastischer Dichtstoff
-  Rundschnur
-  Grundierung I
-  Grundierung II
-  Dichtungsschicht
-  Gewebevlies
-  Verkrallungsschicht
-  Fliesenkleber







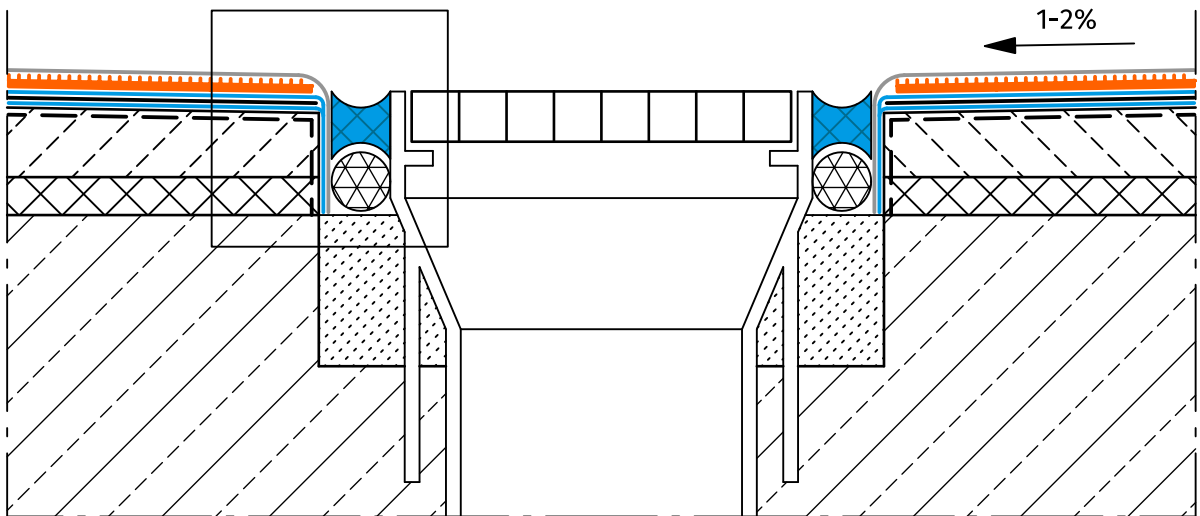
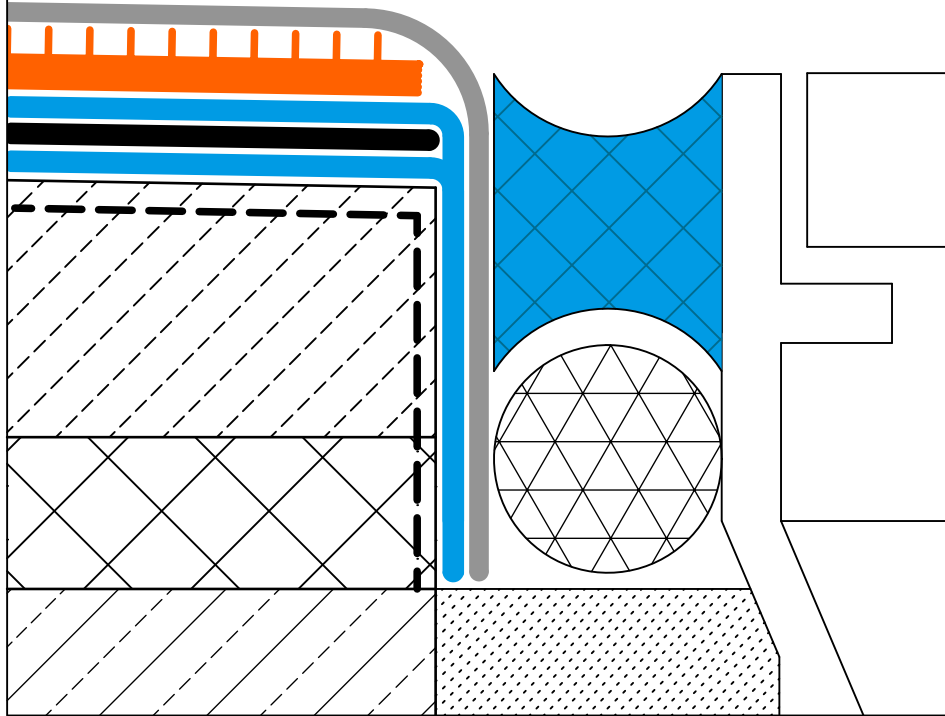

Afdichtingsdetail 08a: buisdoorvoer met tegels

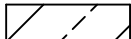
Grundierung I	MC-DUR 1177 WV-A
Grundierung II	je nach Material (siehe Primerliste)
Dichtungsschicht	MC-DUR TopSpeed flex plus
Gewebevlies	MC-Floor Tex
Elastischer Dichtstoff	Mycoflex 488 MS
Rundschnur	geschlossenzellige PE Rundschnur
Verkrallungsschicht	MC-DUR TopSpeed flex plus + Quarzsand
Fliesenkleber	je nach Material

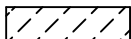
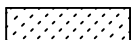
09a



Legende:

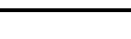





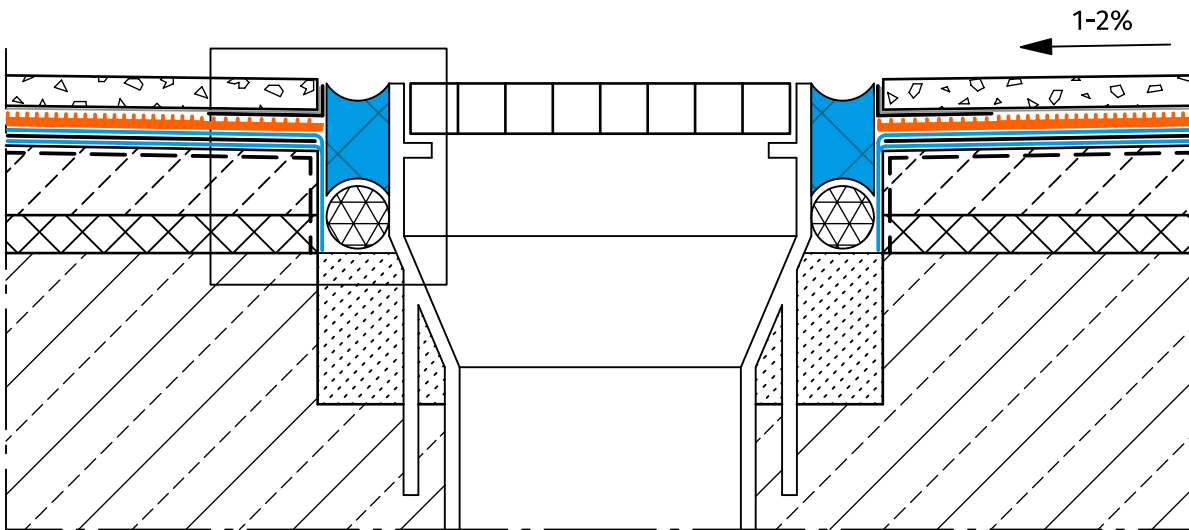
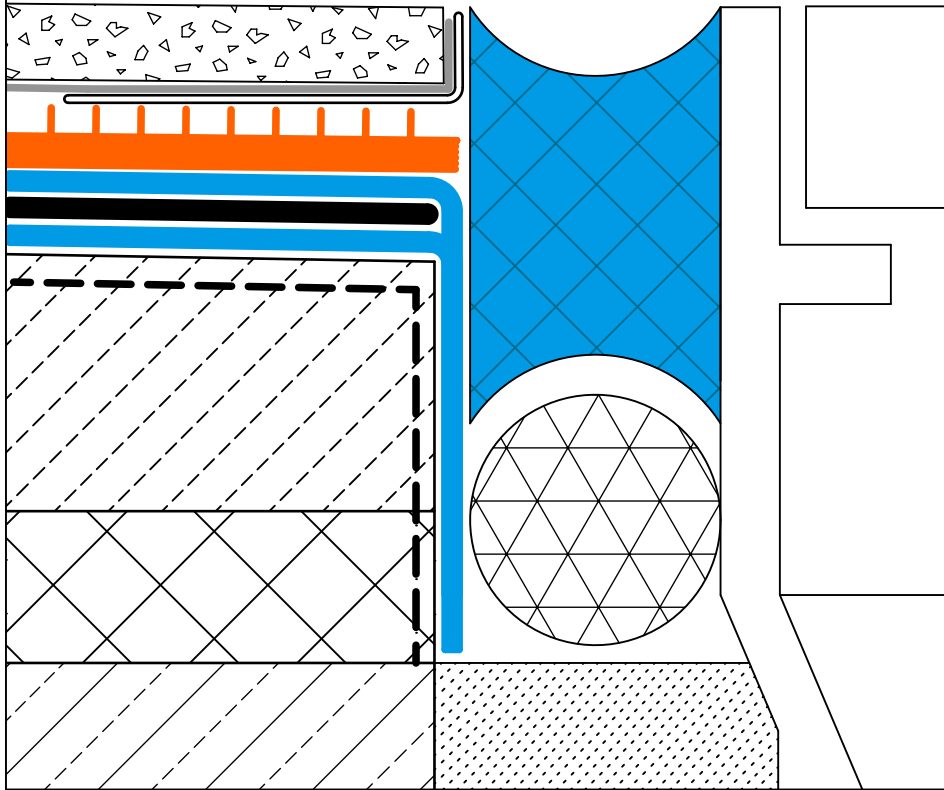

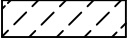

-  Untergrund
-  Dränplatte
-  Gefälleestrich
-  Mörtel
-  Elastischer Dichtstoff
-  Rundschnur
-  Grundierung
-  Dichtungsschicht
-  Verschleißschicht
-  Kopfversiegelung

Afdichtungsdetail 09a: geul zonder flens

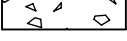
Grundierung	MC-DUR 1177 WV-A
Dichtungsschicht	MC-DUR TopSpeed flex plus
Elastischer Dichtstoff	Mycoflex 488 MS
Rundschnur	geschlossenzellige PE Rundschnur
Verschleißschicht	MC-DUR TopSpeed + Quarzsand
Kopfversiegelung	MC-DUR TopSpeed



Legende:

-  Dränplatte
-  Mörtel
-  Gefälleestrich
-  Elastischer Dichtstoff
-  Rundschnur
-  Fliesen
-  Grundierung
-  Dichtungsschicht
-  Gewebvlies
-  Verkrallungsschicht
-  Fliesenkleber







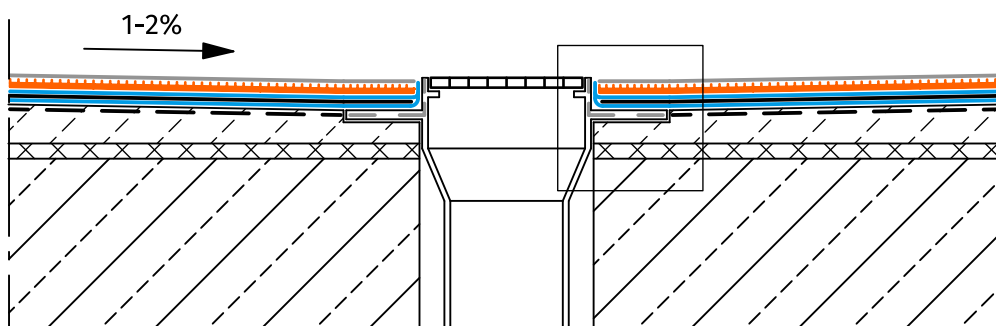
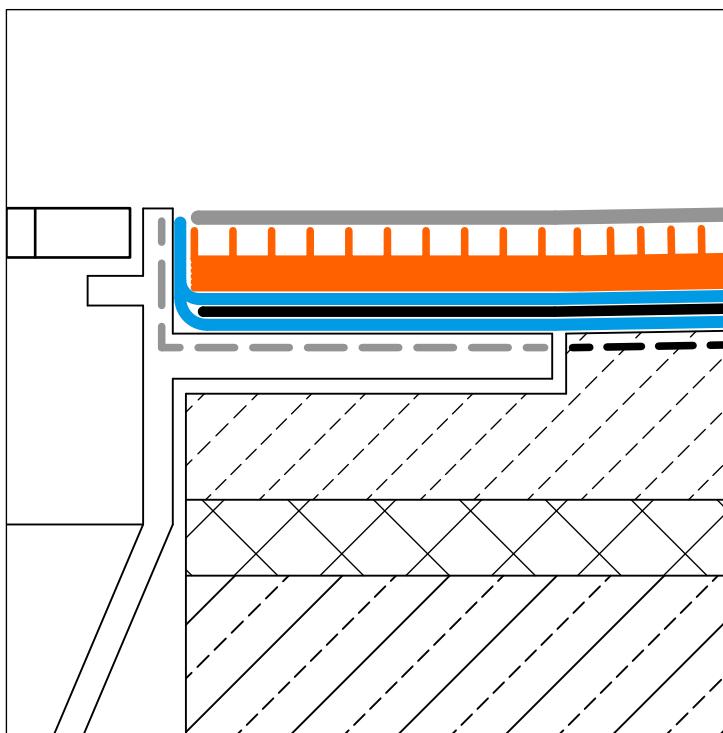

Afdichtingsdetail 09b: geul zonder flens met tegels

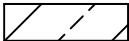
Grundierung	MC-DUR 1177 WV-A
Dichtungsschicht	MC-DUR TopSpeed flex plus
Gewebevlies	MC-Floor Tex
Elastischer Dichtstoff	Mycoflex 488 MS
Rundschnur	geschlossenzellige PE Rundschnur
Verkrallungsschicht	MC-DUR TopSpeed flex plus + Quarzsand
Fliesenkleber	je nach Material

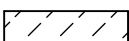
10a



Legende:







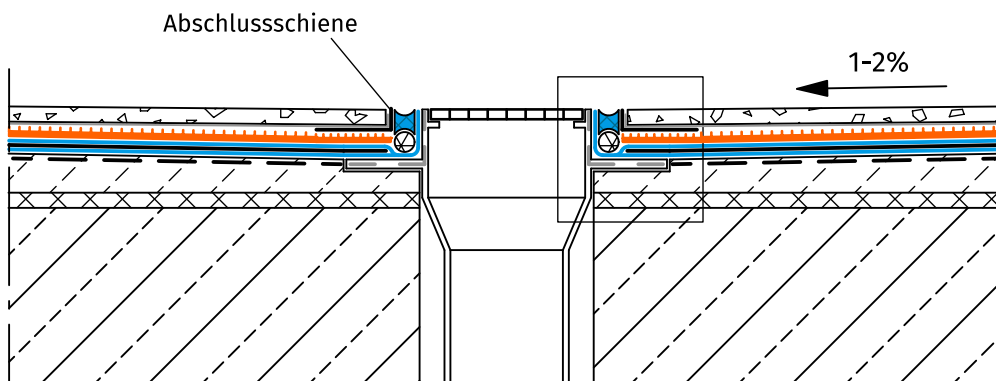
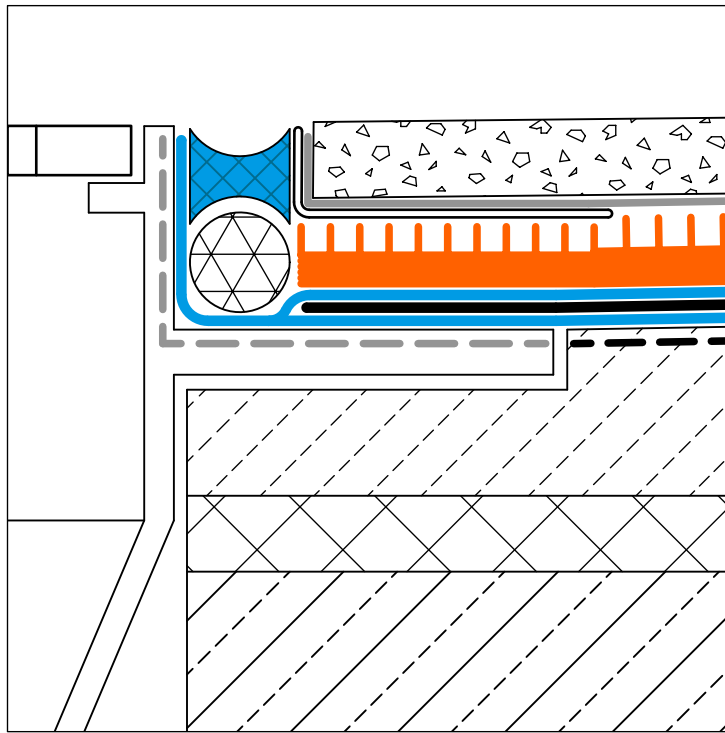

-  Untergrund
-  Dränplatte
-  Gefälleestrich
-  Grundierung I
-  Grundierung II
-  Dichtungsschicht
-  Gewebvlies
-  Verschleißschicht
-  Kopfversiegelung

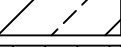
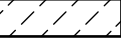
Afdichtungsdetail 10a: geul met flens

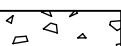
Grundierung I	MC-DUR 1177 WV-A
Grundierung II	je nach Material (siehe Primerliste)
Dichtungsschicht	MC-DUR TopSpeed flex plus
Gewebvlies	MC-Floor Tex
Verschleißschicht	MC-DUR TopSpeed + Quarzsand
Kopfversiegelung	MC-DUR TopSpeed



Legende:

-  Untergrund
-  Gefälleestrich
-  Dränplatte
-  Fliesen
-  Grundierung I
-  Grundierung II
-  Dichtungsschicht
-  Gewebevlies
-  Verkrallungsschicht
-  Fliesenkleber



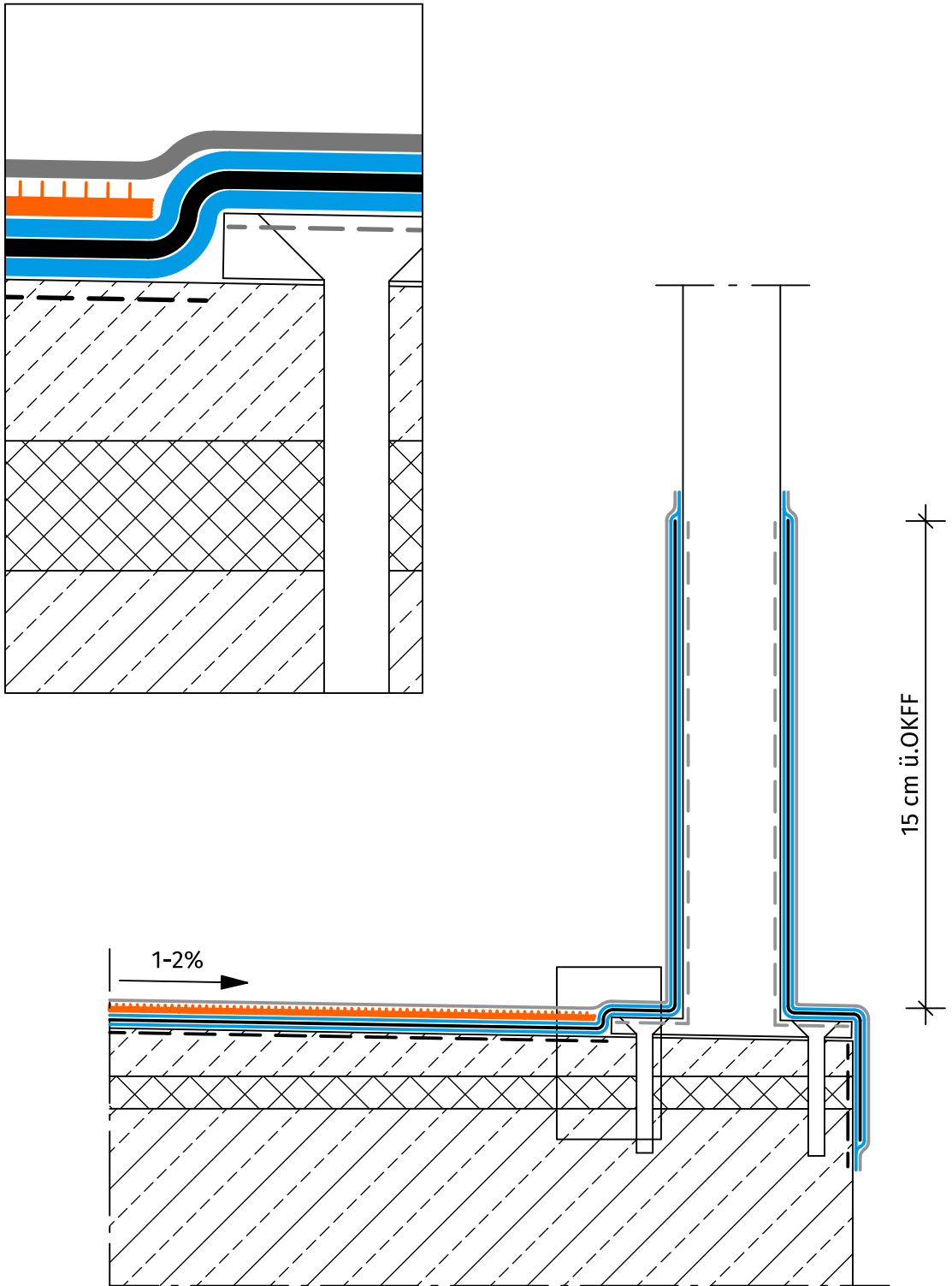

Afdichtungsdetail 10b: geul met flens en tegels

Grundierung I	MC-DUR 1177 WV-A
Grundierung II	je nach Material (siehe Primerliste)
Dichtungsschicht	MC-DUR TopSpeed flex plus
Gewebevlies	MC-Floor Tex
Verkrallungsschicht	MC-DUR TopSpeed flex plus + Quarzsand
Fliesenkleber	je nach Material

11a

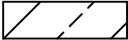

Legende:

-  Untergrund
-  Gefälleestrich
-  Dränplatte
-  Grundierung I
-  Grundierung II
-  Dichtungsschicht
-  Gewebevlies
-  Verschleißschicht
-  Kopfversiegelung

Afdichtingsdetail 11a:Relingvoet

Grundierung I	MC-DUR 1177 WV-A
Grundierung II	je nach Material (siehe Primerliste)
Dichtungsschicht	MC-DUR TopSpeed flex plus
Gewebevlies	MC-Floor Tex
Verschleißschicht	MC-DUR TopSpeed + Quarzsand
Kopfversiegelung	MC-DUR TopSpeed

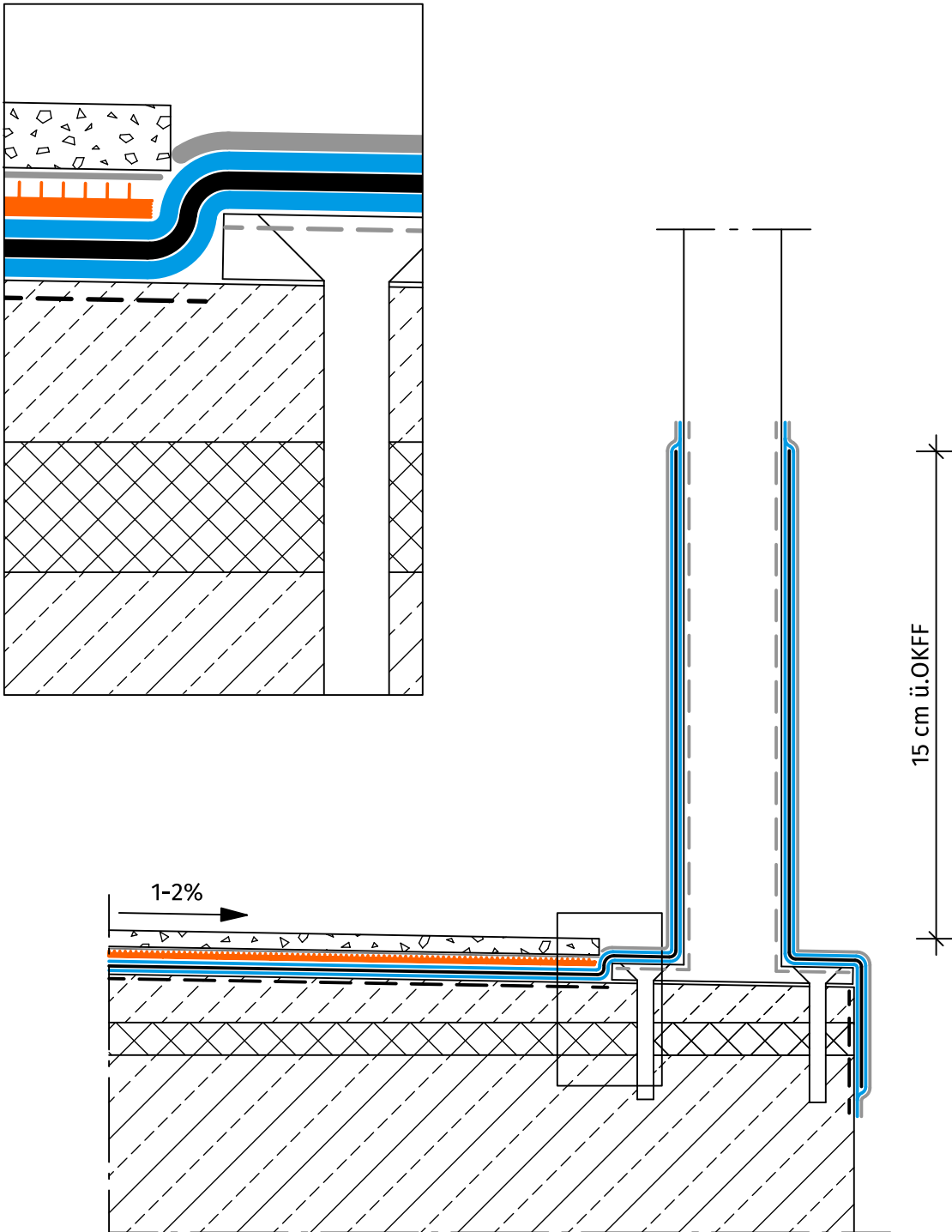

Legende:

-  Untergrund
-  Gefälleestrich
-  Dränplatte
-  Fliesen
-  Grundierung I
-  Grundierung II
-  Dichtungsschicht
-  Gewebevlies
-  Verkrallungsschicht
-  Fliesenkleber

Afdichtingsdetail 11b:relingvoet met tegels

Grundierung I	MC-DUR 1177 WV-A
Grundierung II	je nach Material (siehe Primerliste)
Dichtungsschicht	MC-DUR TopSpeed flex plus
Gewebevlies	MC-Floor Tex
Verkrallungsschicht	MC-DUR TopSpeed flex plus + Quarzsand
Fliesenkleber	je nach Material

MC-DUR TopSpeed

Het veelzijdige afdichtingssysteem voor balkons, loggia's, galerijen en daken.

MC-Bouwchemie Nederland
Het Eek 9b
4004 LM Tiel
Tel. +31 344 633700
info@mc-bouwchemie.nl
www.mc-bouwchemie.com

MC-Bauchemie Belgium N.V.
Bedrijvenpark „La Corbeille“
Conservenstraat 25
BE-2235 Westmeerbeek
Tel. +32 15 201462
info@mc-bauchemie.be
www.mc-bauchemie.com



BE SURE. BUILD SURE.

Contact gegevens
MC-Bouwchemie Nederland



Contact gegevens
MC-Bauchemie Belgium N.V.

